

INSTRUKCJA MONTAZU  
FITTING-UP INSTRUCTION  
AUFBAUANLEITUNG

TOPAZ  
WIESZAK

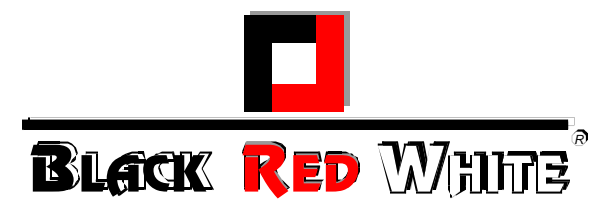

Producent:  
**BLACKREDWHITES.A.**  
UL. KRZESZOWSKA 63  
23-400 BILGORAJ

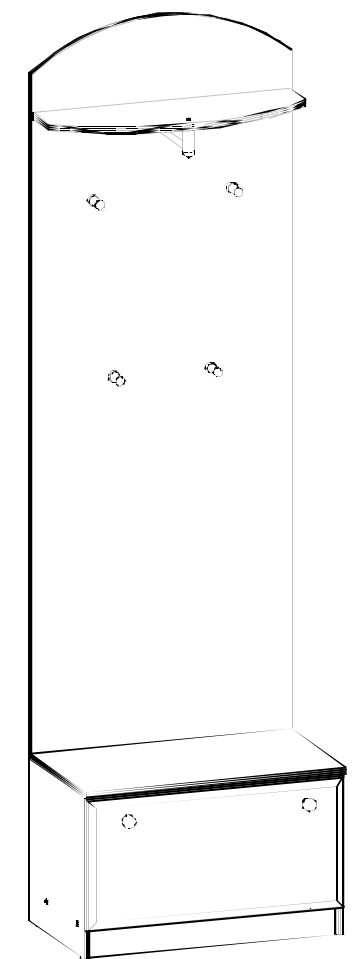

201x60x36,5/cm/

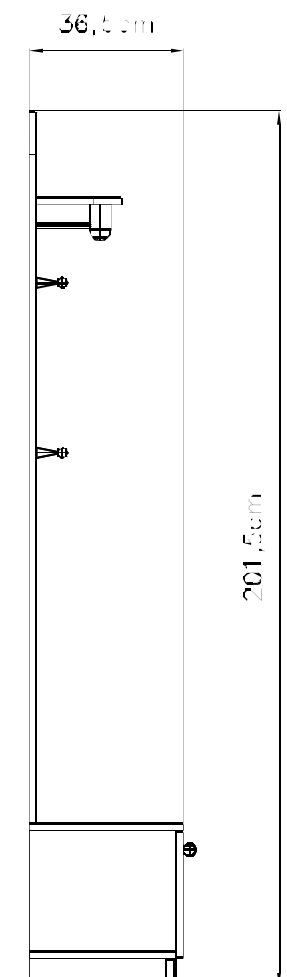
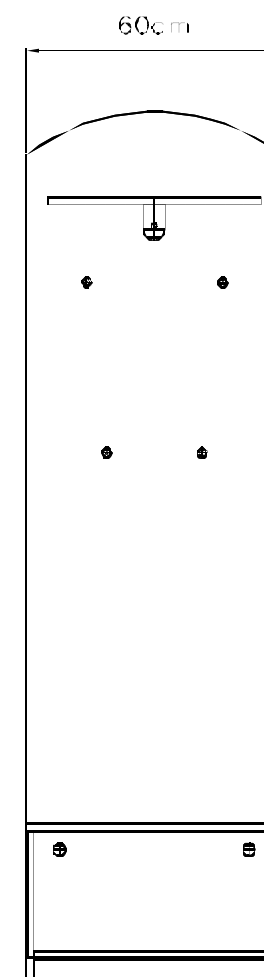

# TOPAZ

## WIEZAK

Paczka/Package/Paket-KORPUS/BODY/  
MÖBELKORPSnr2  
Paczka/Package/Paket-KORPUS/BODY/  
MÖBELKORPSnr3  
Paczka/Package/Paket-FRONTY/FRONTS/  
MÖBELFRONTENnr4  
Paczka/Package/Paket-PLECY/BACKSIDE/  
RÜCKENPLATTENnr6  
Paczka/Package/Paket-AKCESORIA/ACCESSORIES/  
ZUBEHÖRnr7

Wybrać paczki elementy:  
To haul from pack these units:  
Wählen Sie diese Elemente aus der Packung aus:

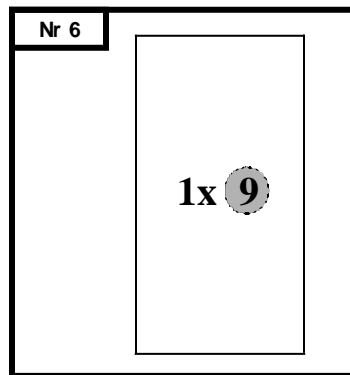
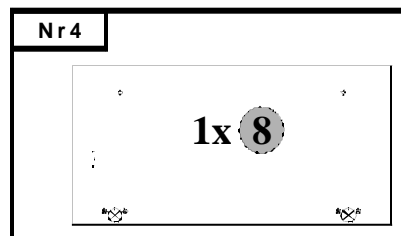
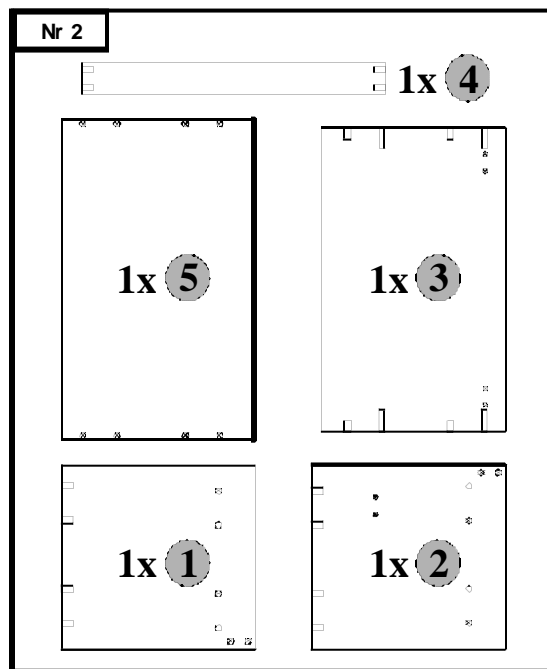
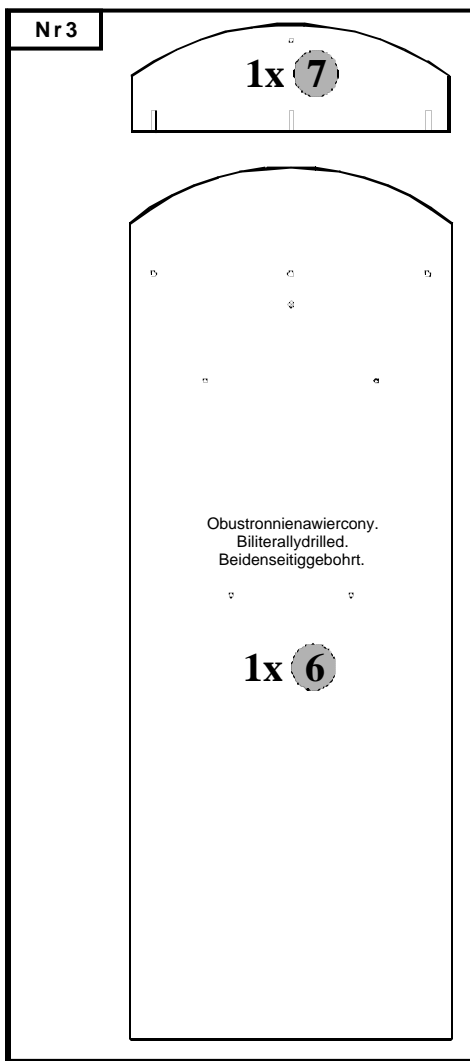

Symbol elementu Element symbol Elementeszeichen	Wymiary Measurements Ausmaß	Kod Code Kode
1	362x345	TP1- 104
2	362x345	TP1- 105/A
3	567x345	TP1- 305
4	567x60	TP1- 401
5	600x360	TP1- 201
6	1630x600	TP1- 203/A
7	592x200	TP1- 304
8	596x296	TP1- 003/A
9	315x595	TP1- 903

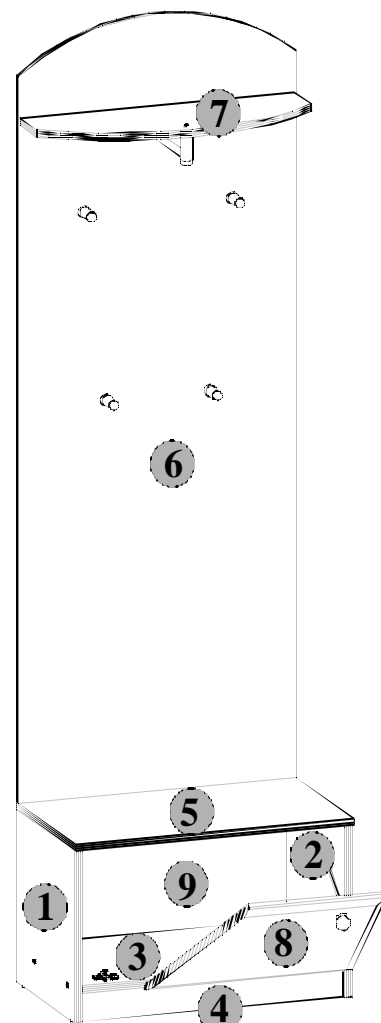
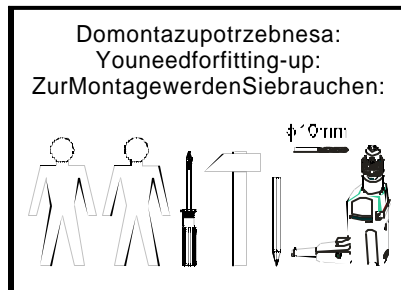
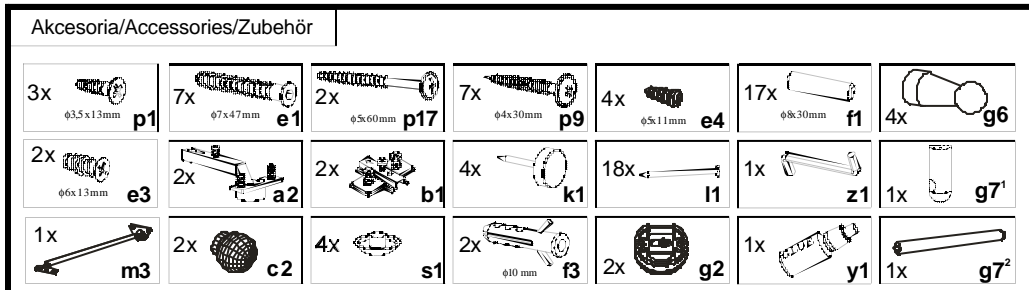

Podczas montażu  
postępować  
zgodnie z instrukcją.

While assembling  
follow  
the instruction.

Montagelaut  
der Aufbauanleitung  
durchführen.

## 8 TOPAZ - "B"

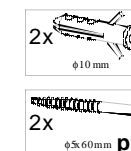
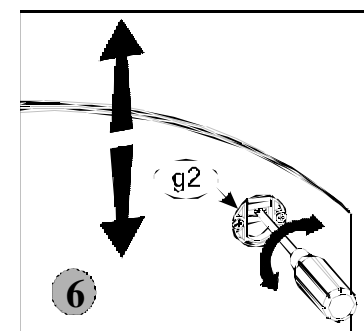
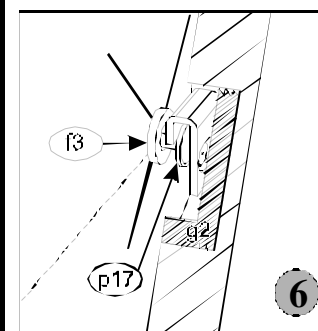
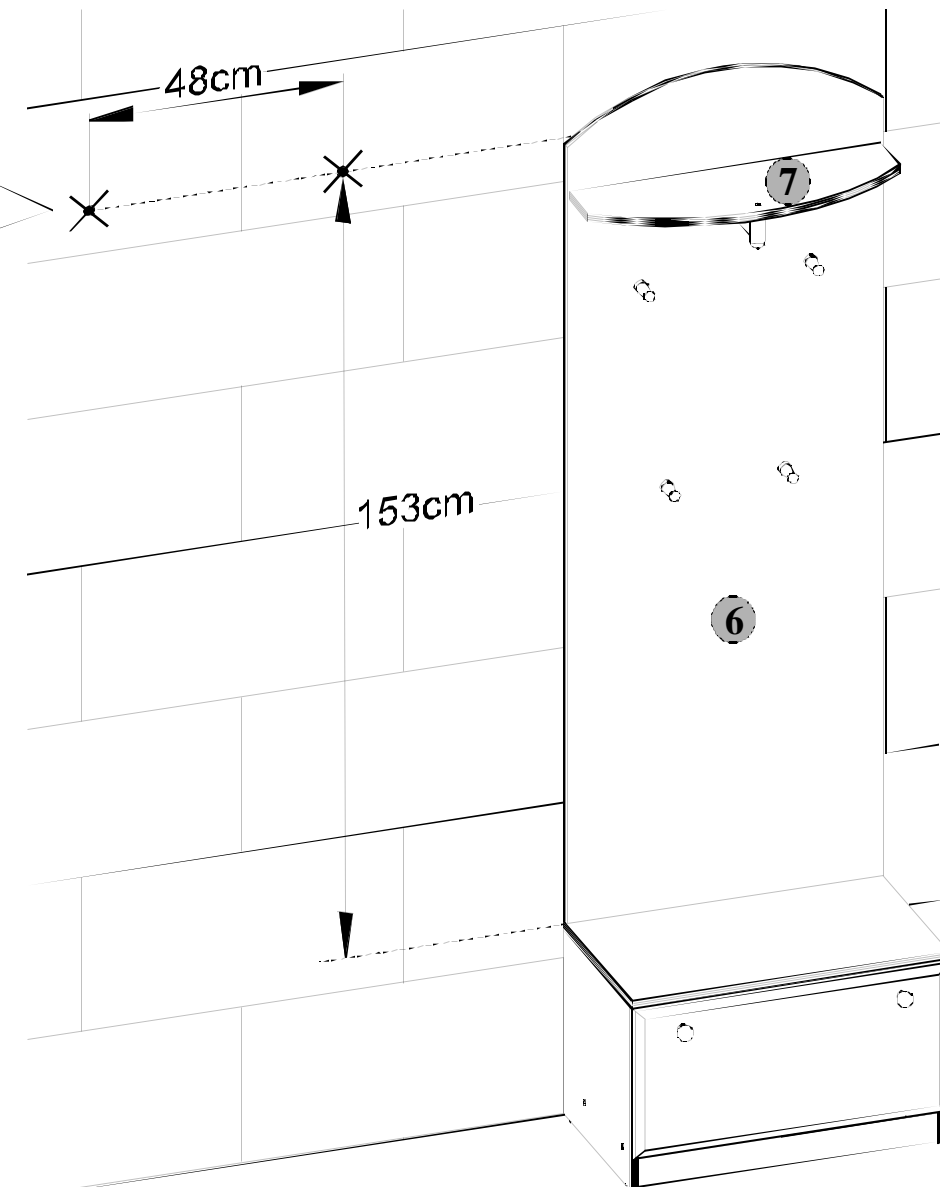
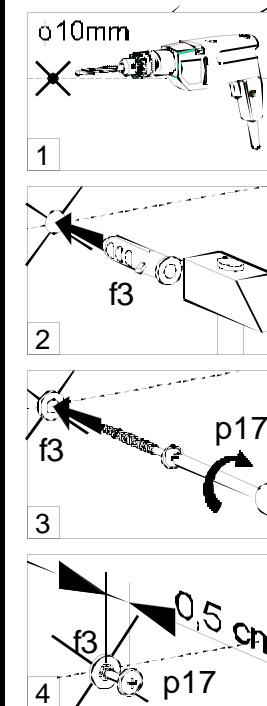

Podczas montażu  
postępowac  
zgodnie z instrukcją.

While assembling  
follow  
the instruction.

Montagelaut  
der Aufbauanleitung  
durchführen.

# 6 TOPAZ - "B"

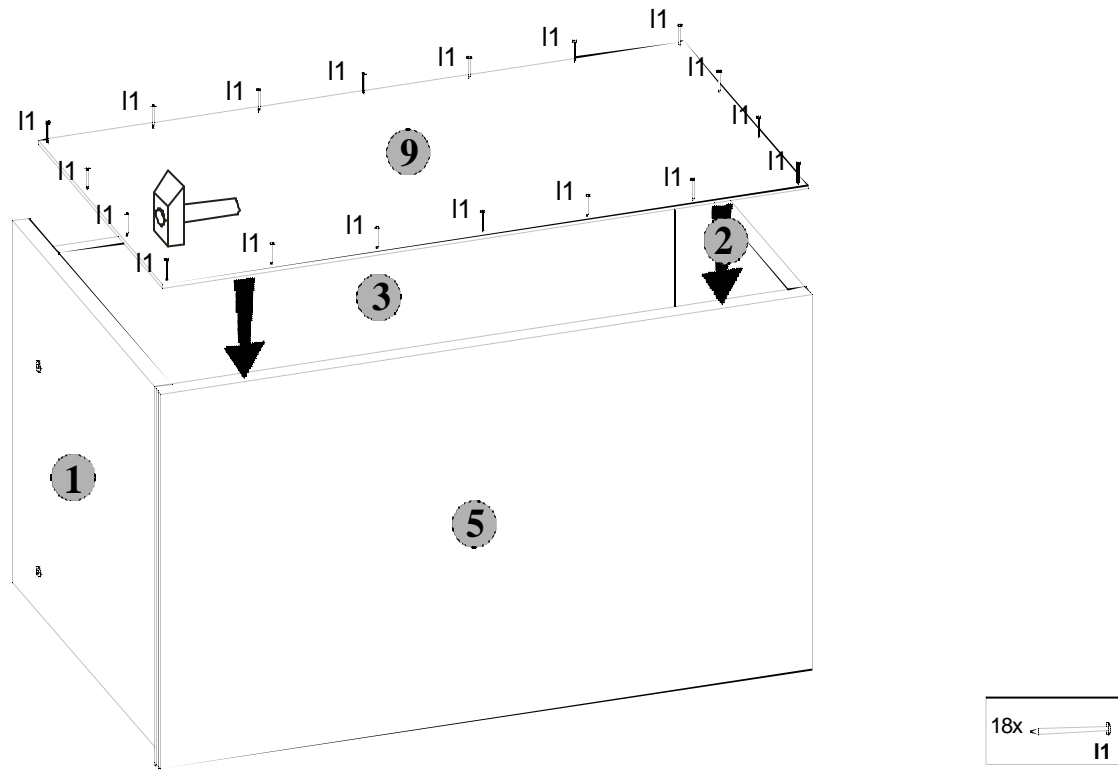

# 7 TOPAZ - "B"

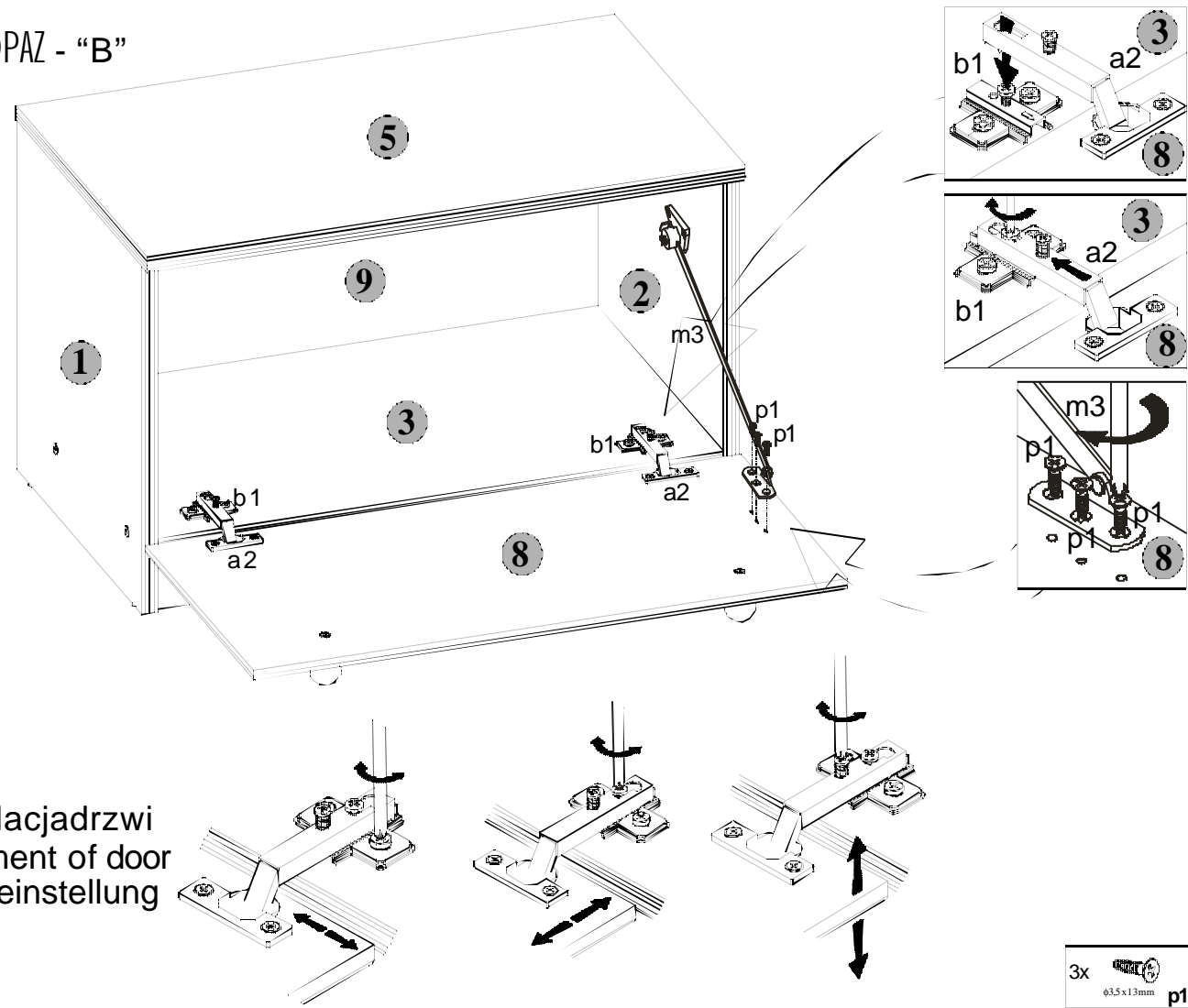

Regulacja drzwi  
Adjustment of door  
Türeneinstellung

Podczas montażu  
postępowac  
zgodnie z instrukcją.

While assembling  
follow  
the instruction.

Montagelaut  
der Aufbauanleitung  
durchführen.

# 1 TOPAZ - "B"

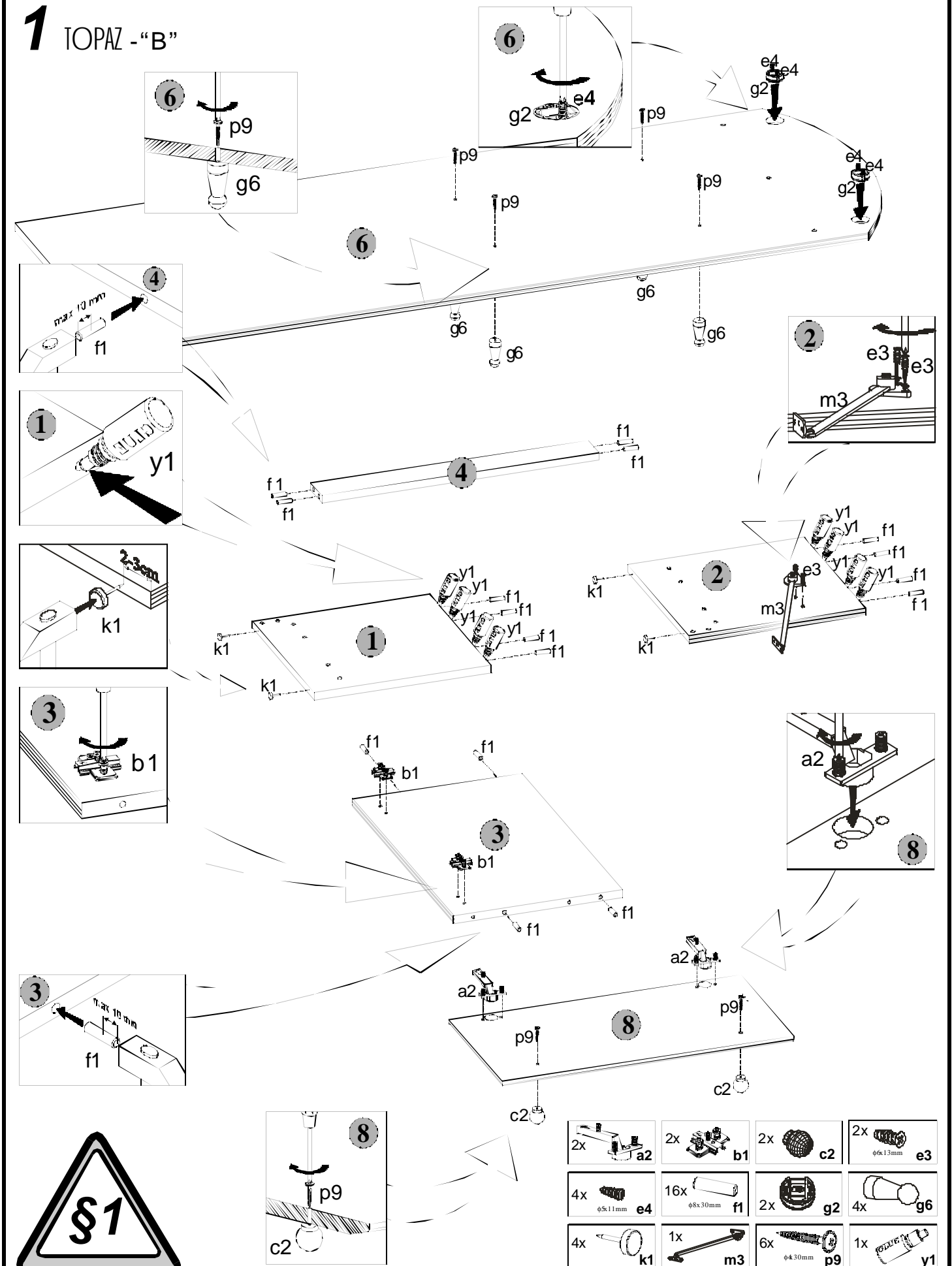

2x	a2	2x	b1	2x	c2	2x	e3
4x	e4	16x	f1	2x	g2	4x	g6
4x	k1	1x	m3	6x	p9	1x	y1

Podczas montażu  
postępowac  
zgodnie z instrukcją.

While assembling  
follow  
the instruction.

Montagelaut  
der Aufbauanleitung  
durchführen.

## 2 TOPAZ - "B"

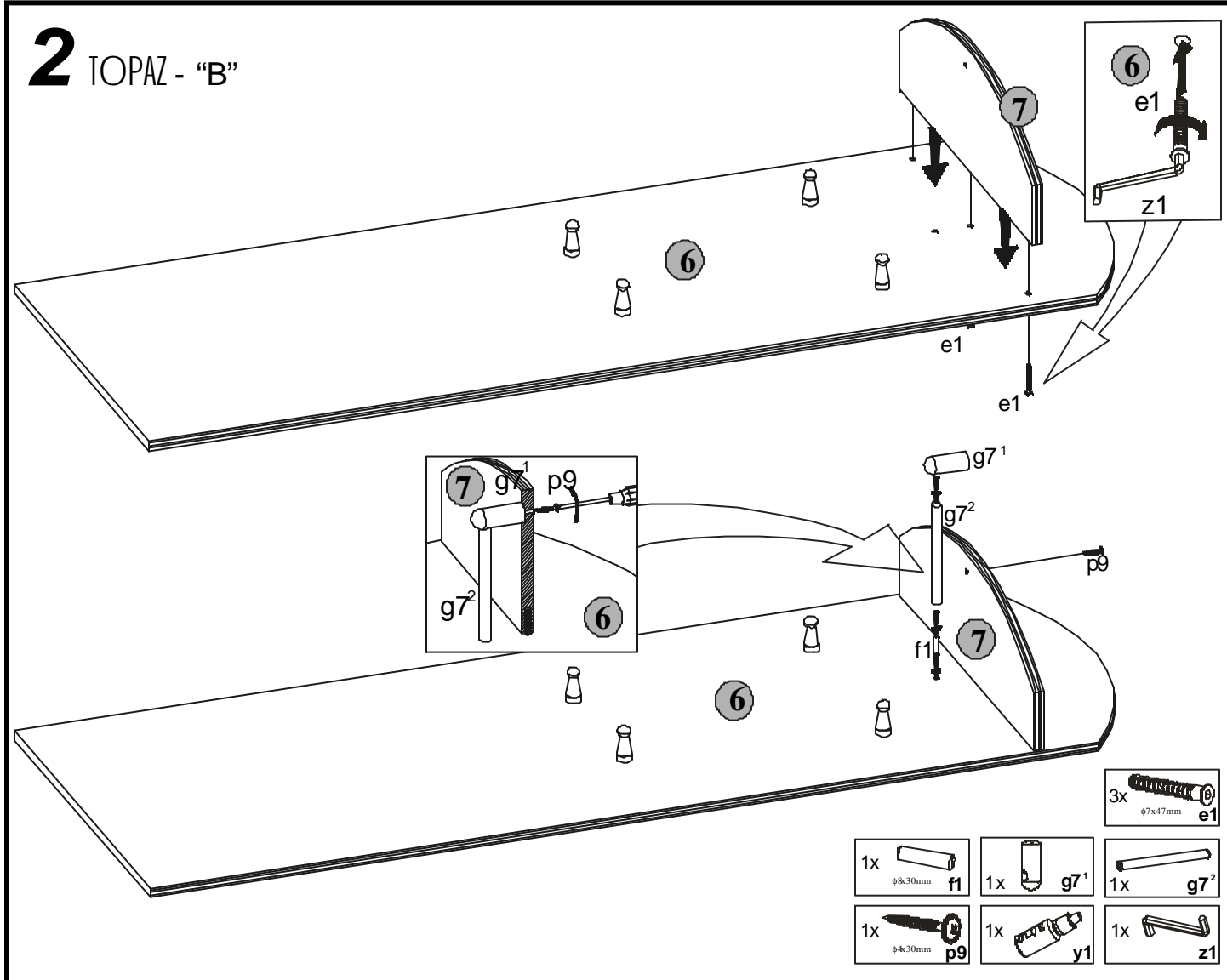

Podczas montażu  
postępowac  
zgodnie z instrukcją.

While assembling  
follow  
the instruction.

Montagelaut  
der Aufbauanleitung  
durchführen.

## 4 TOPAZ - "B"

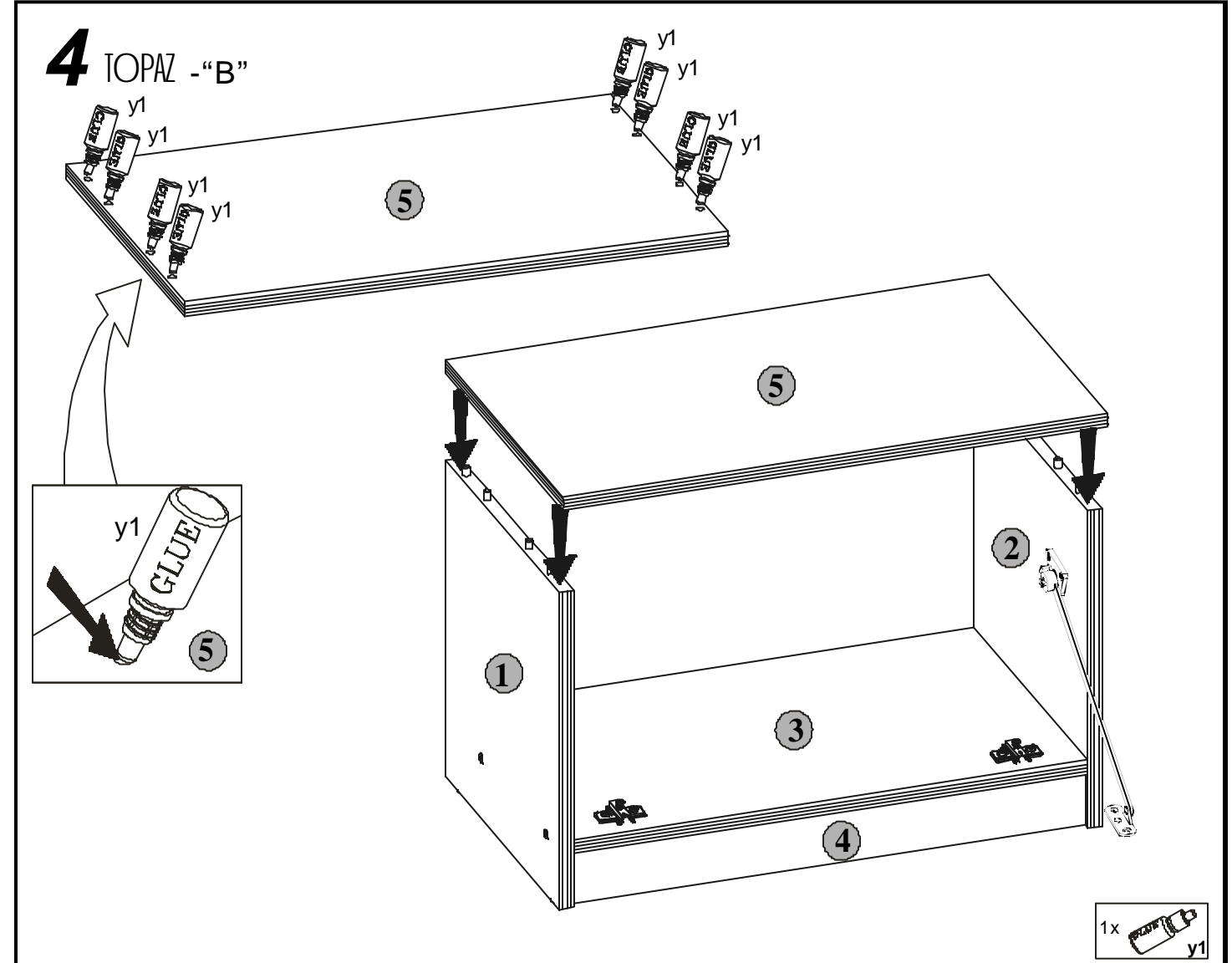

## 3 TOPAZ - "B"

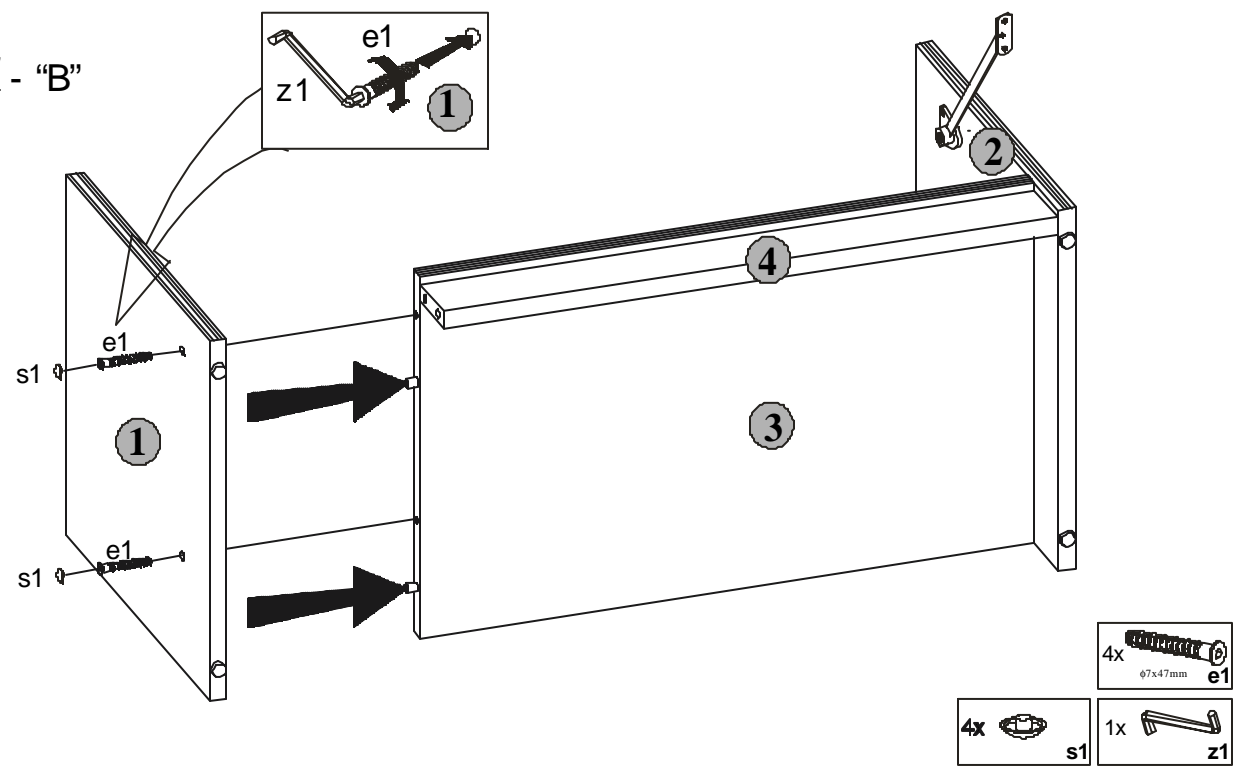

## 5 TOPAZ - "B"

