

THE ASSEMBLY MANUAL,

Attention: Before you start the assembly, please get acquainted with the entire assembly manual and stick to the order of assembly presented in this manual.

TOLEDO RANGE

TOL1W

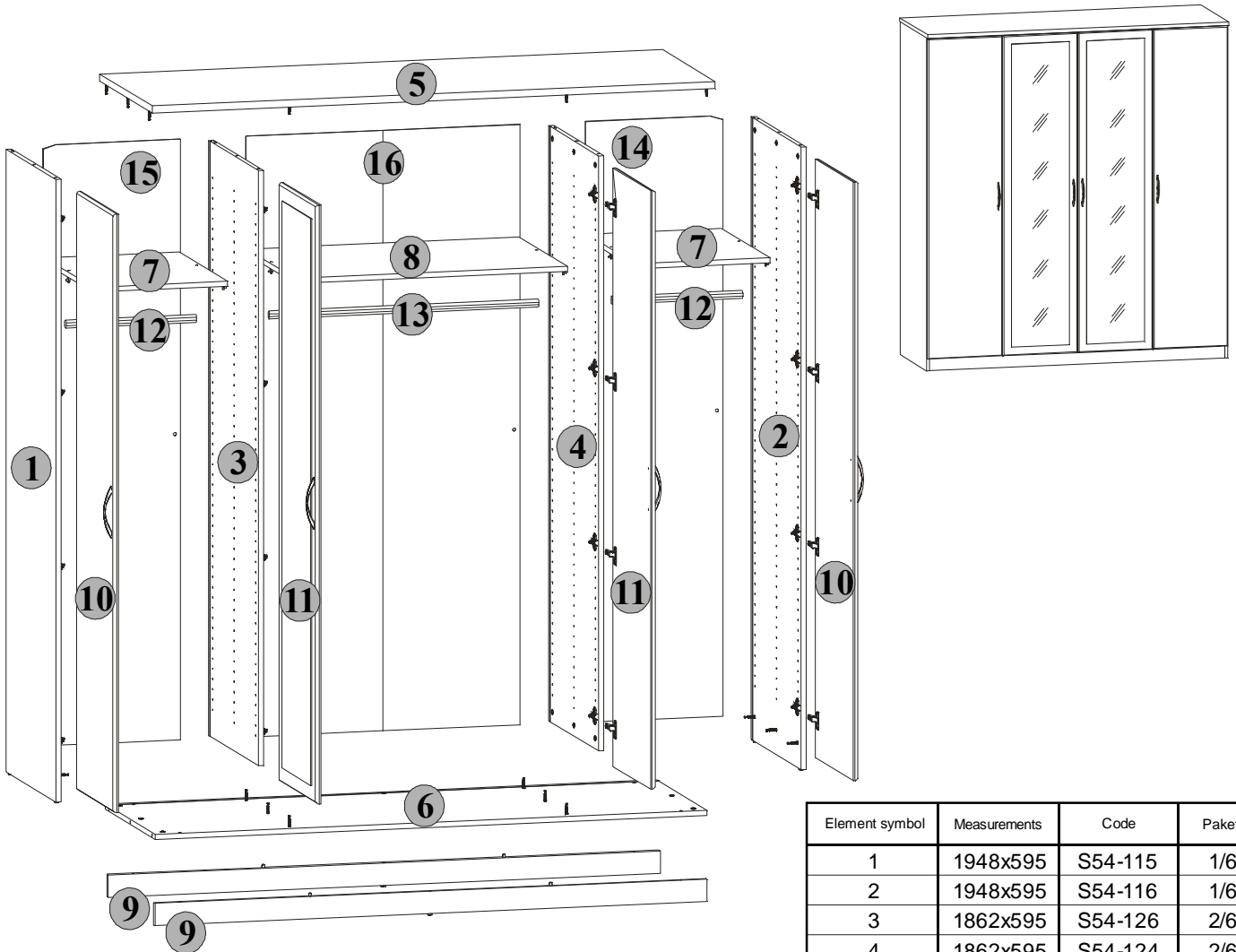

Element symbol	Measurements	Code	Paket
1	1948x595	S54-115	1/6
2	1948x595	S54-116	1/6
3	1862x595	S54-126	2/6
4	1862x595	S54-124	2/6
5	1798x625	S54-212	3/6
6	1764x595	S54-315	2/6
7	431x574	S54-316	3/6
8	870x574	S54-314	3/6
9	1764x70	S54-412	3/6
10	1873x446	S54-021	6/6
11	1873x446	S54-024	5/6
12	418x24	dr-418	3/6
13	857x24	dr-857	3/6
14	1879x439	S54-917	1/6
15	1879x439	S54-925	1/6
16	1879x877	S54-926	1/6

You need for fitting-up:

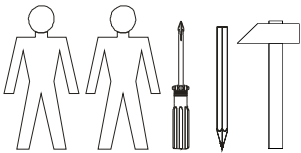

The symbols and the amount of accessories needed for the assembly have been presented below. The accessories can be found in the "Accessories" package.

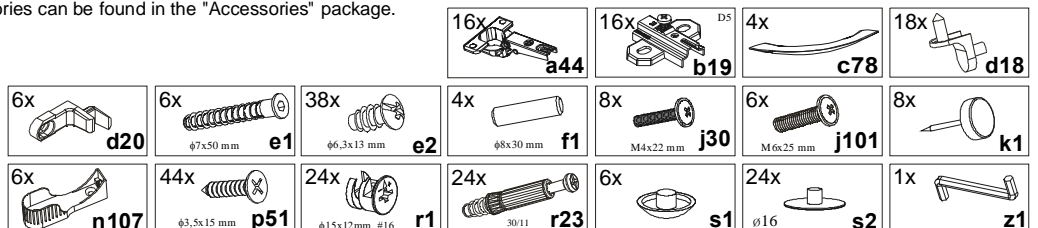
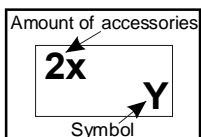



The first stage of the assembly is equipping the elements with the appropriate accessories according to the drawings below. The Ⓞ symbols denote places to which special attention should be paid during the assembly.

1 TOL1W

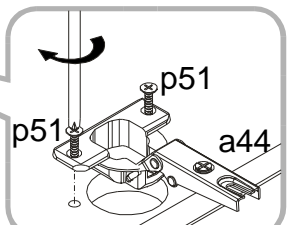
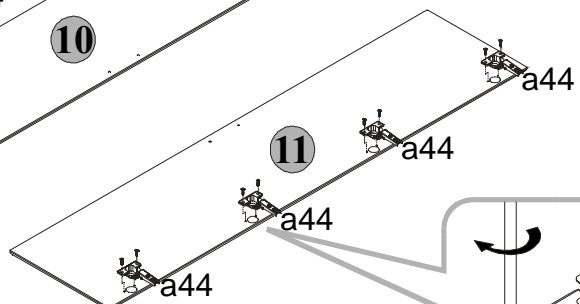
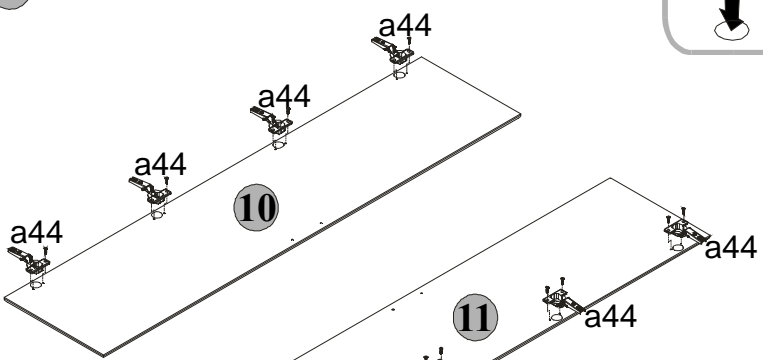
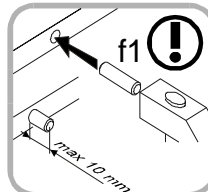
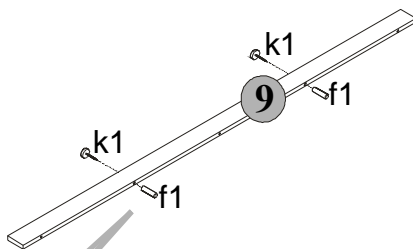
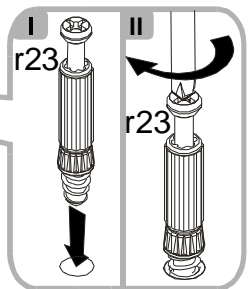
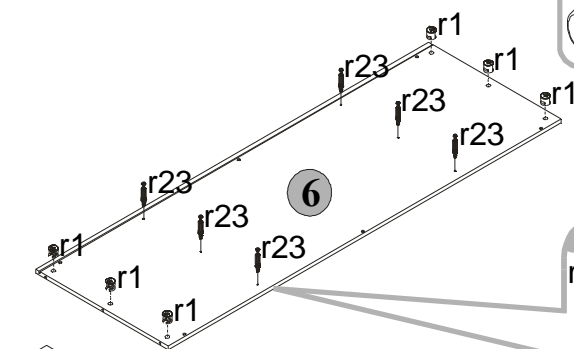
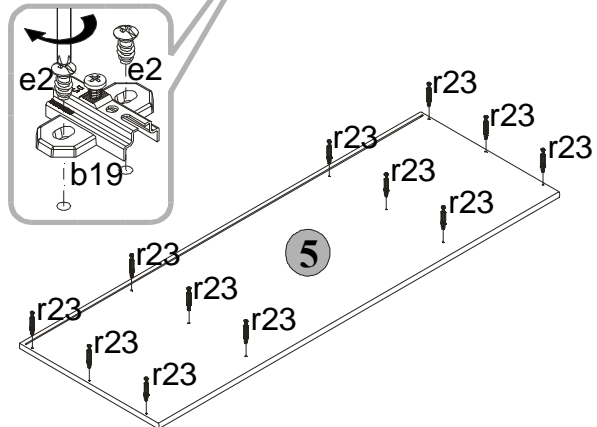
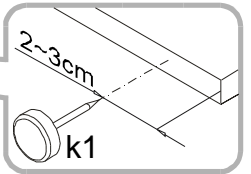
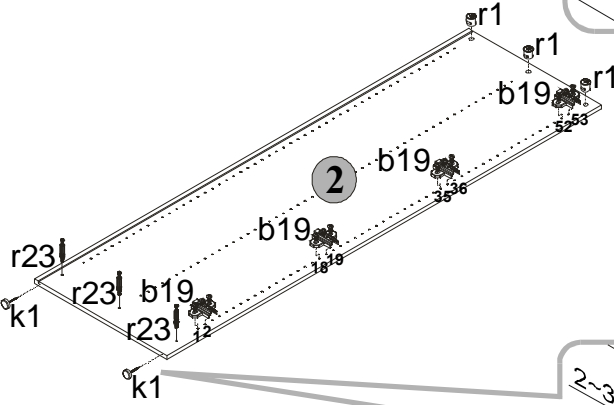
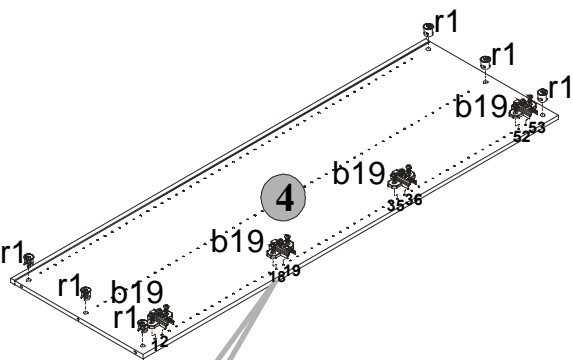
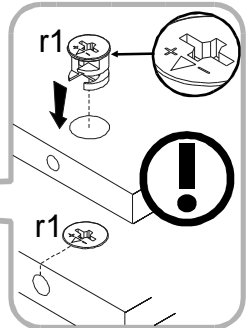
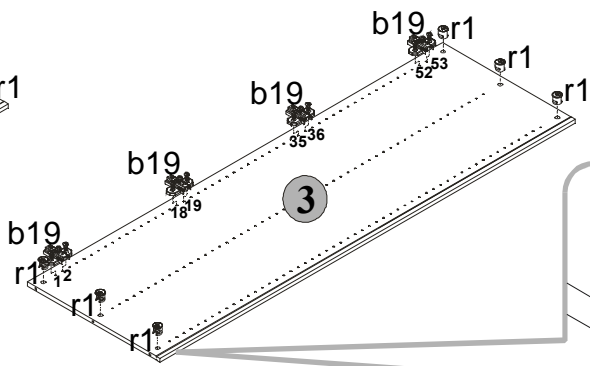
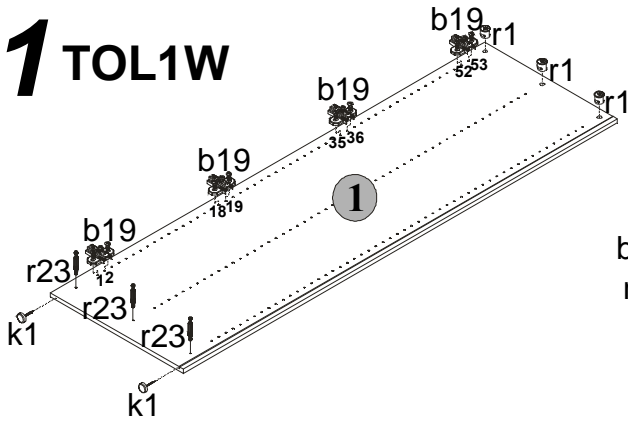

You need for fitting-up:

16x a44	16x b19	38x e2 φ6,3x13 mm	4x f1 φ8x30 mm
8x k1	32x p51 φ3,5x15 mm	24x r1 φ15x12mm #16	24x r23 3011



Assemble the unit as shown in the pictures using indicated connectors and/or joints.

2 TOL1W

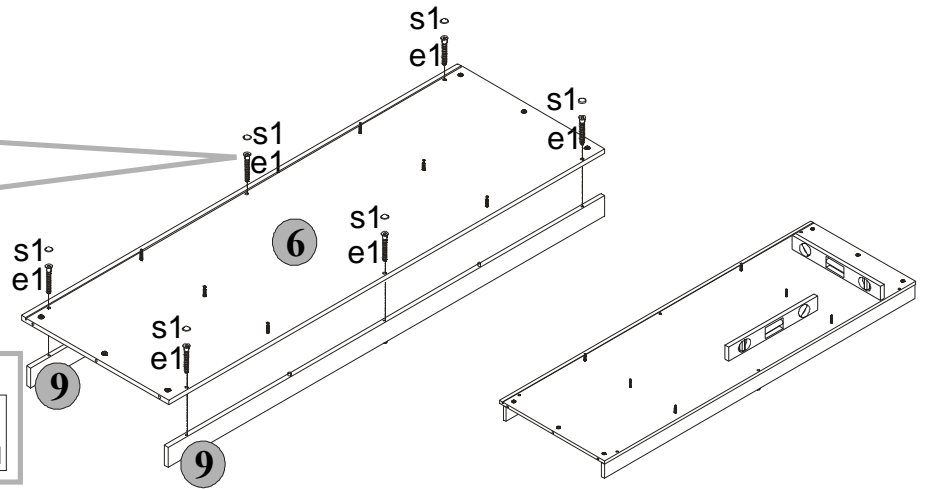
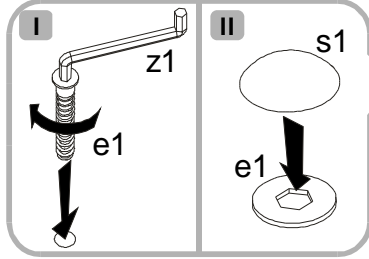

You need for fitting-up:

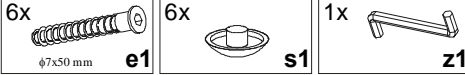

3 TOL1W

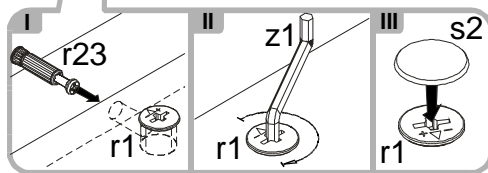
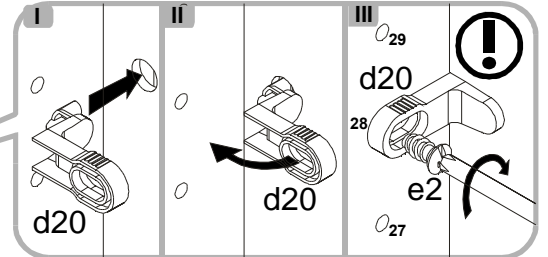
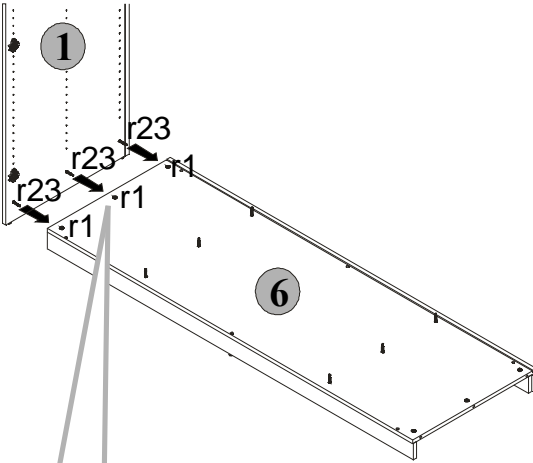

You need for fitting-up:

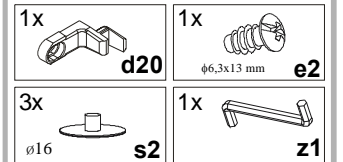

4 TOL1W

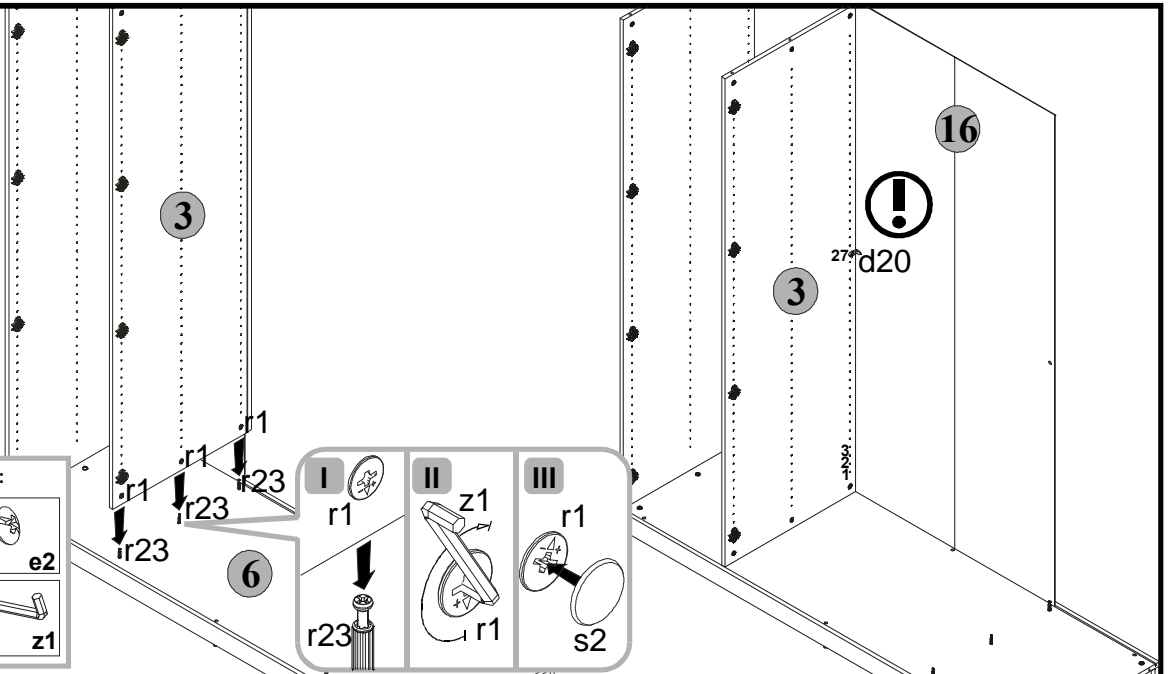

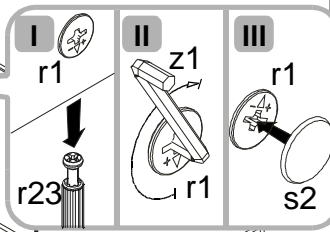
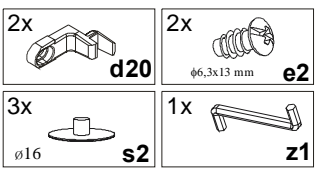

You need for fitting-up:

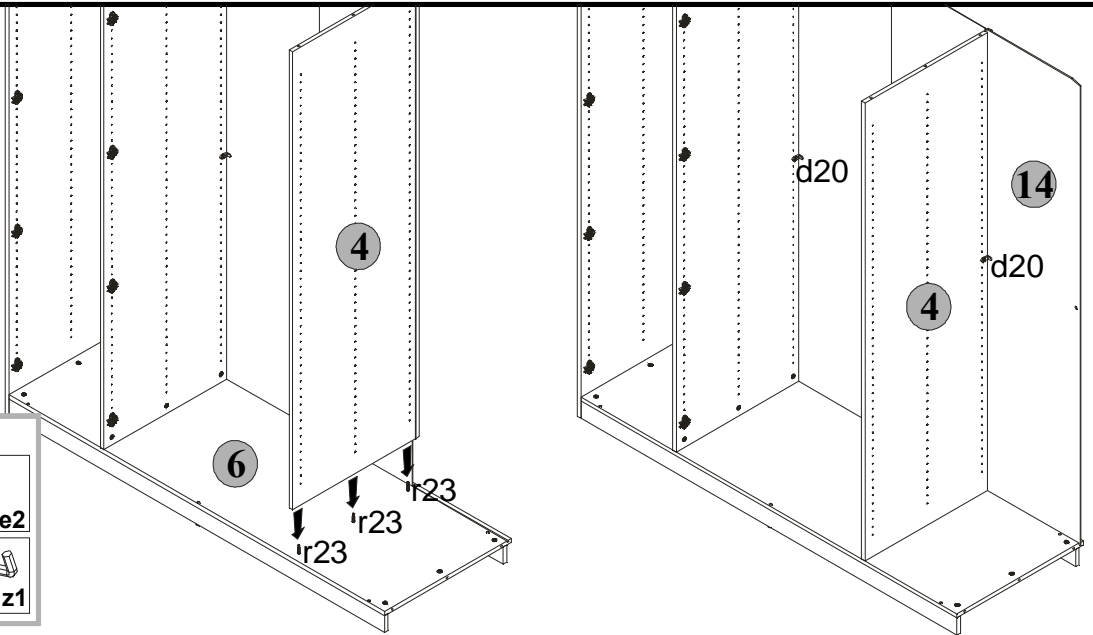

5 TOL1W

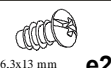

You need for fitting-up:

2x  d20	2x  φ6.3x13 mm e2
3x  ø16 s2	1x  z1

6 TOL1W

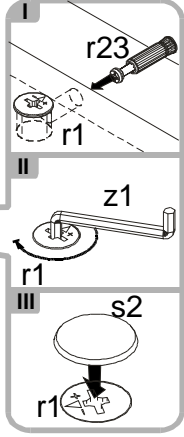
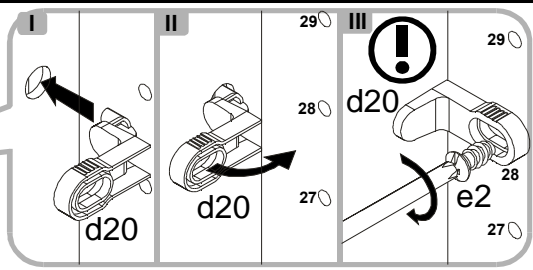
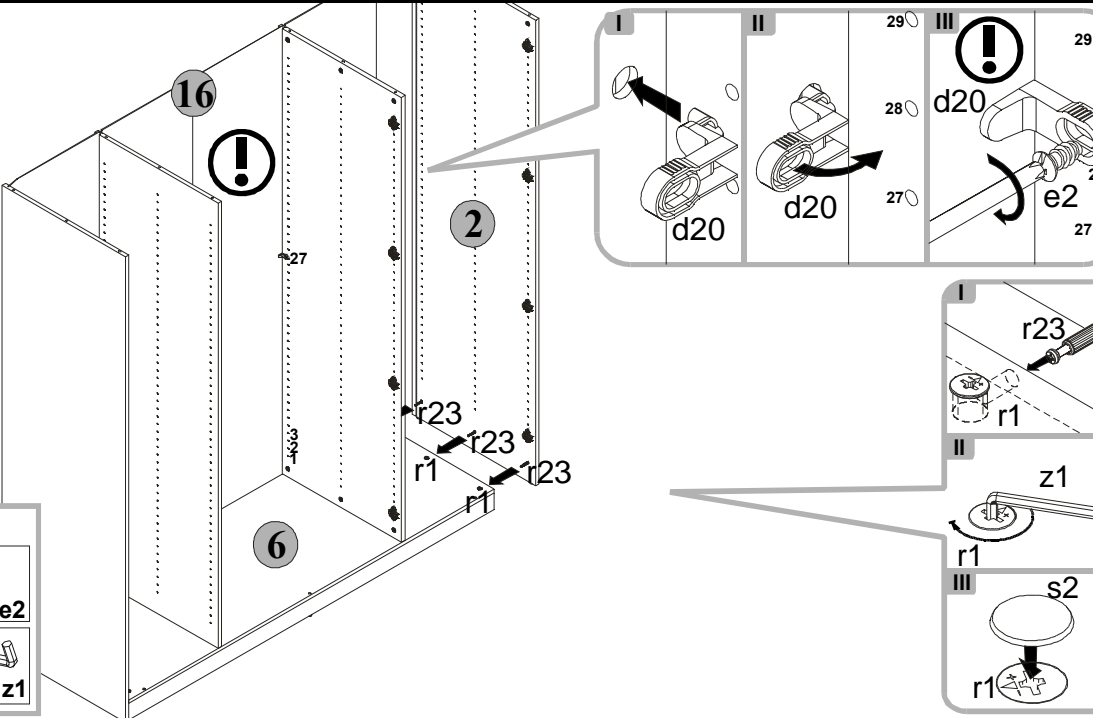

You need for fitting-up:

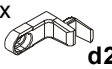
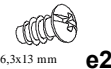
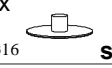
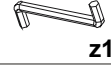
1x  d20	1x  φ6.3x13 mm e2
3x  ø16 s2	1x  z1

7 TOL1W

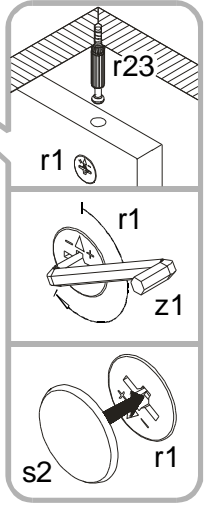
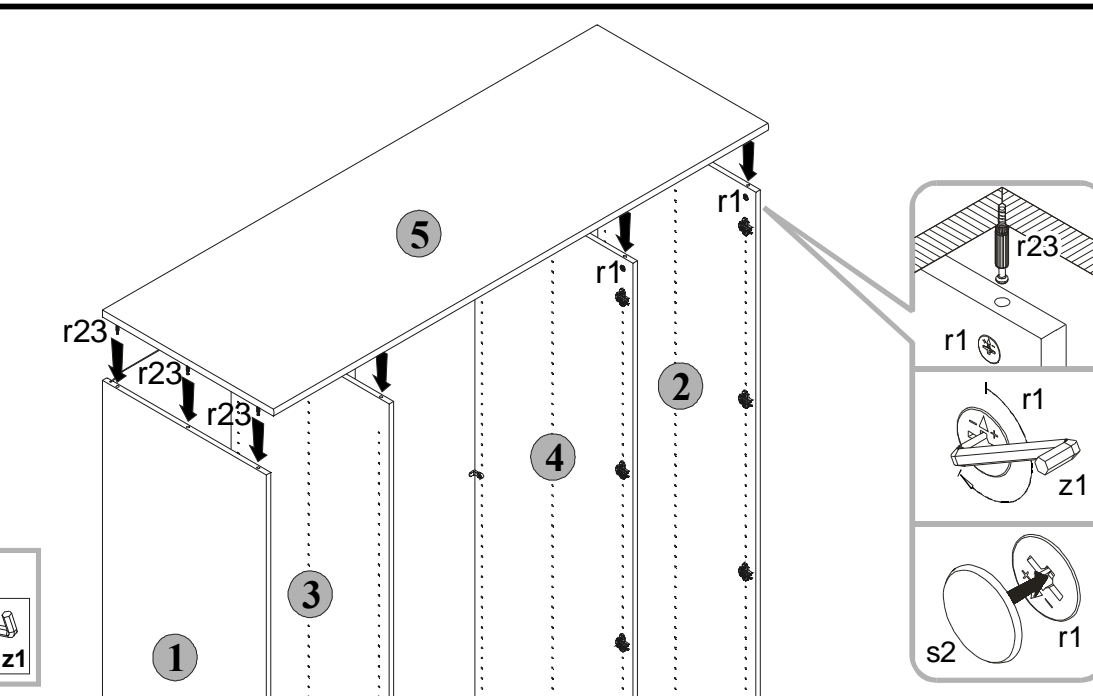

You need for fitting-up:

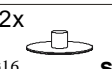
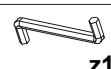
12x  ø16 s2	1x  z1
--	---

8 TOL1W

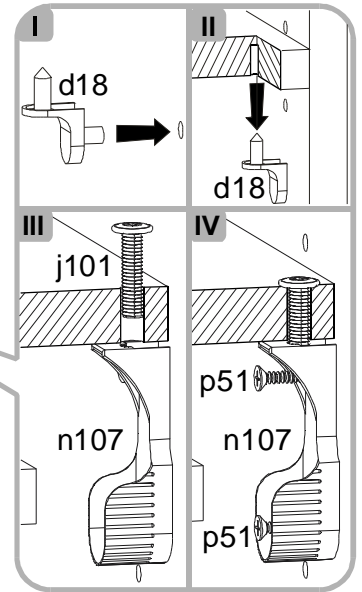
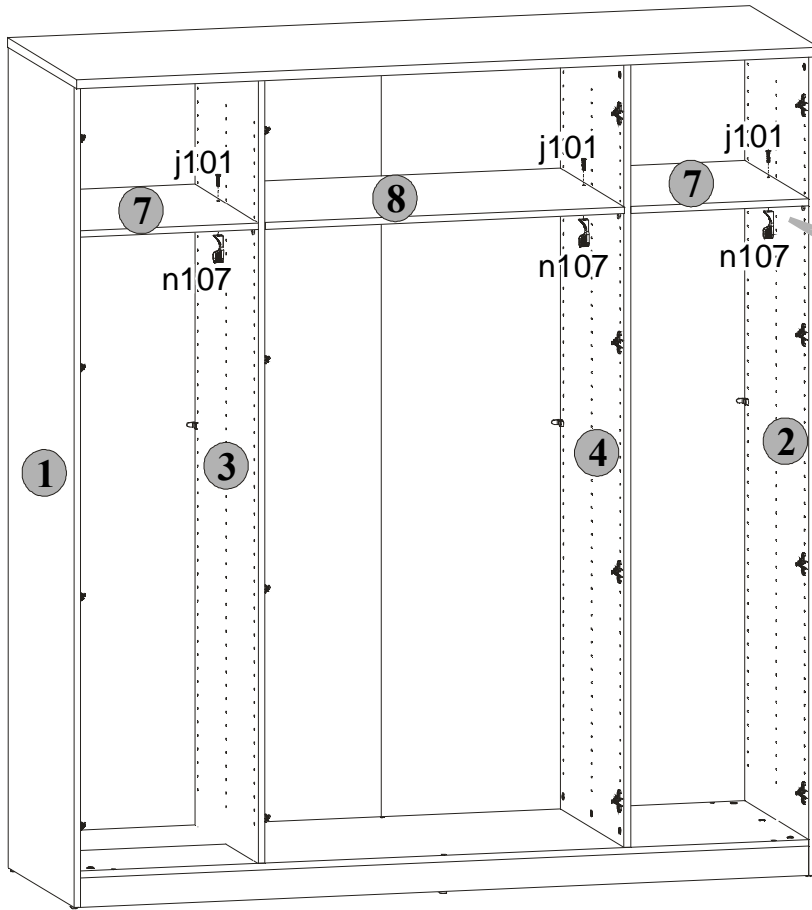

You need for fitting-up:

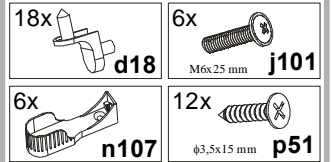

9 TOL1W

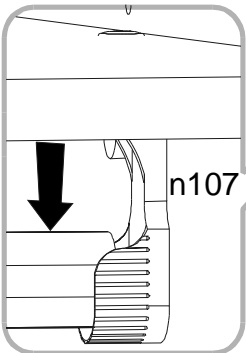
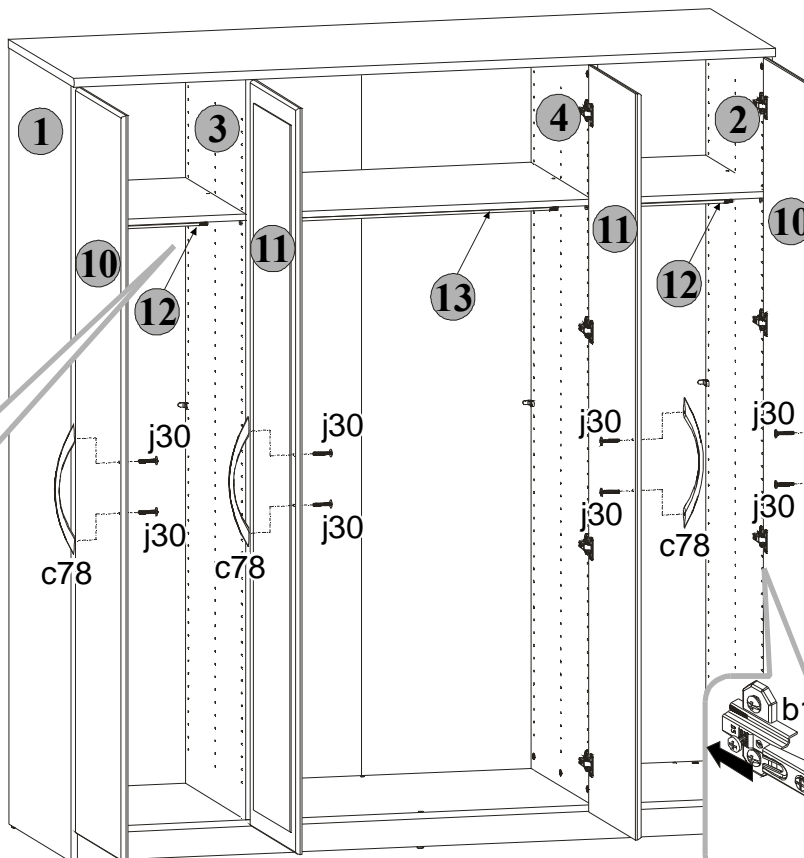

You need for fitting-up:

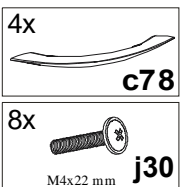

Adjustment of door

