

THE ASSEMBLY MANUAL,

Attention: Before you start the assembly, please get acquainted with the entire assembly manual and stick to the order of assembly presented in this manual.

TOLEDO RANGE

TOL2W

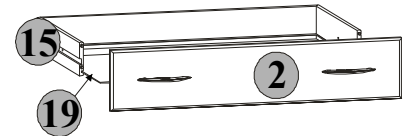
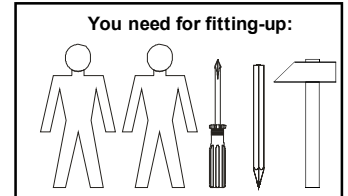
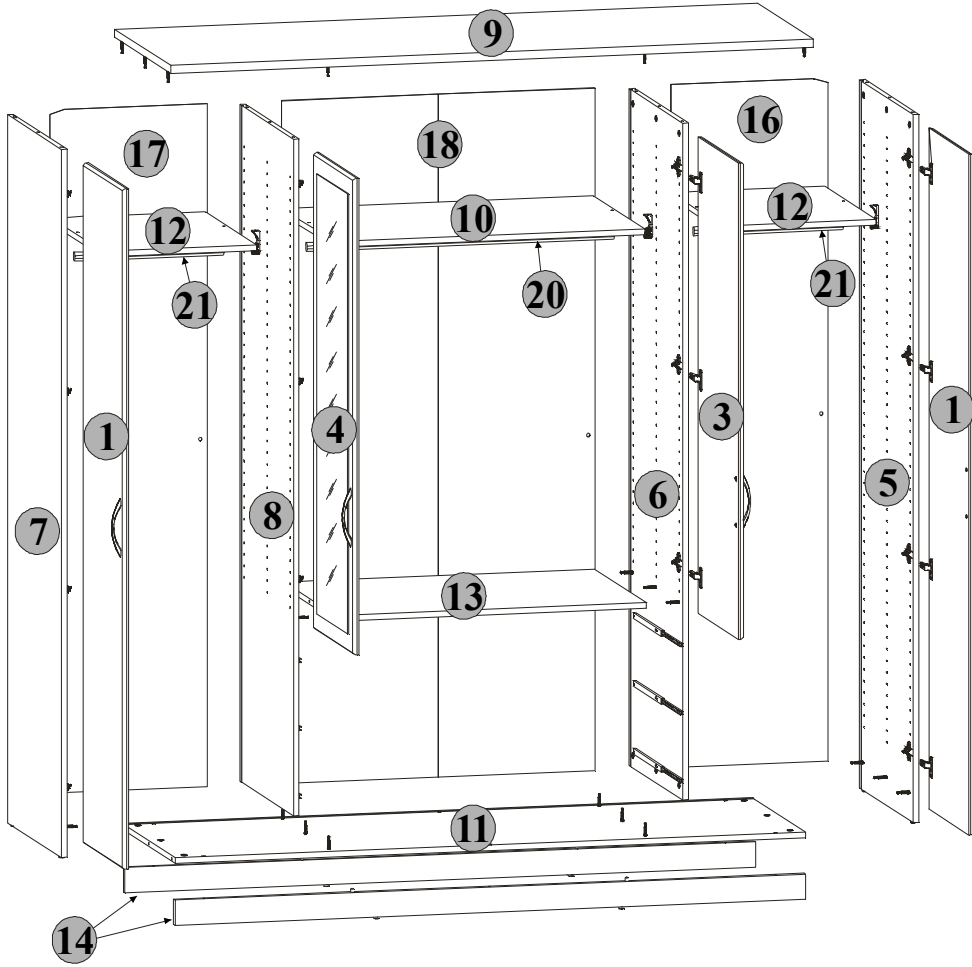

The symbols and the amount of accessories needed for the assembly have been presented below. The accessories can be found in the "Accessories" package.

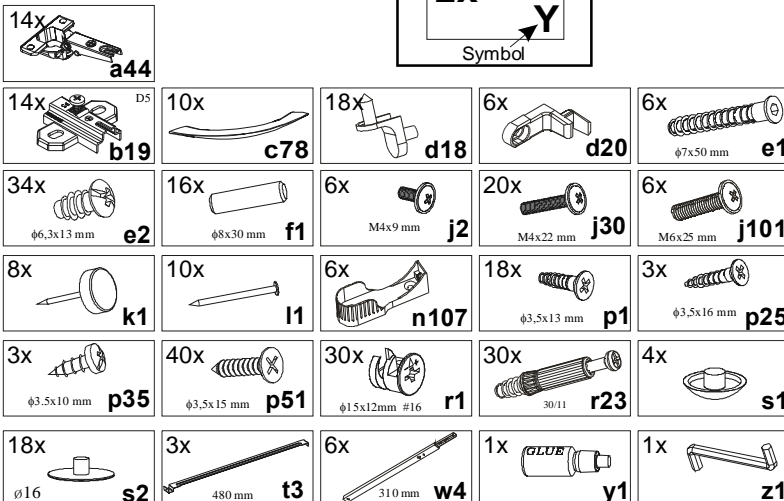
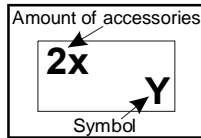

Element symbol	Measurements	Code	Paket
1	1873x446	S54-021	6/6
2	893x184	S54-025	6/6
3	1311x446	S54-022	5/6
4	1311x446	S54-027	5/6
5	1948x595	S54-116	1/6
6	1862x595	S54-125	2/6
7	1948x595	S54-115	1/6
8	1862x595	S54-128	2/6
9	1798x625	S54-212	3/6
10	870x574	S54-314	2/6
11	1764x595	S54-315	3/6
12	431x574	S54-316	3/6
13	870x575	S54-322	2/6
14	1764x70	S54-412	2/6
15	1823x100	S54-516	1/6
16	1879x439	S54-917	1/6
17	1879x439	S54-925	1/6
18	1879x887	S54-926	1/6
19	849x481	S54-927	1/6
20	857x24	dr-857	2/6
21	418x24	dr-418	2/6



The first stage of the assembly is equipping the elements with the appropriate accessories according to the drawings below. The Ⓞ symbols denote places to which special attention should be paid during the assembly.

1 TOL2W

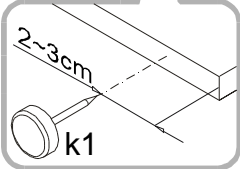
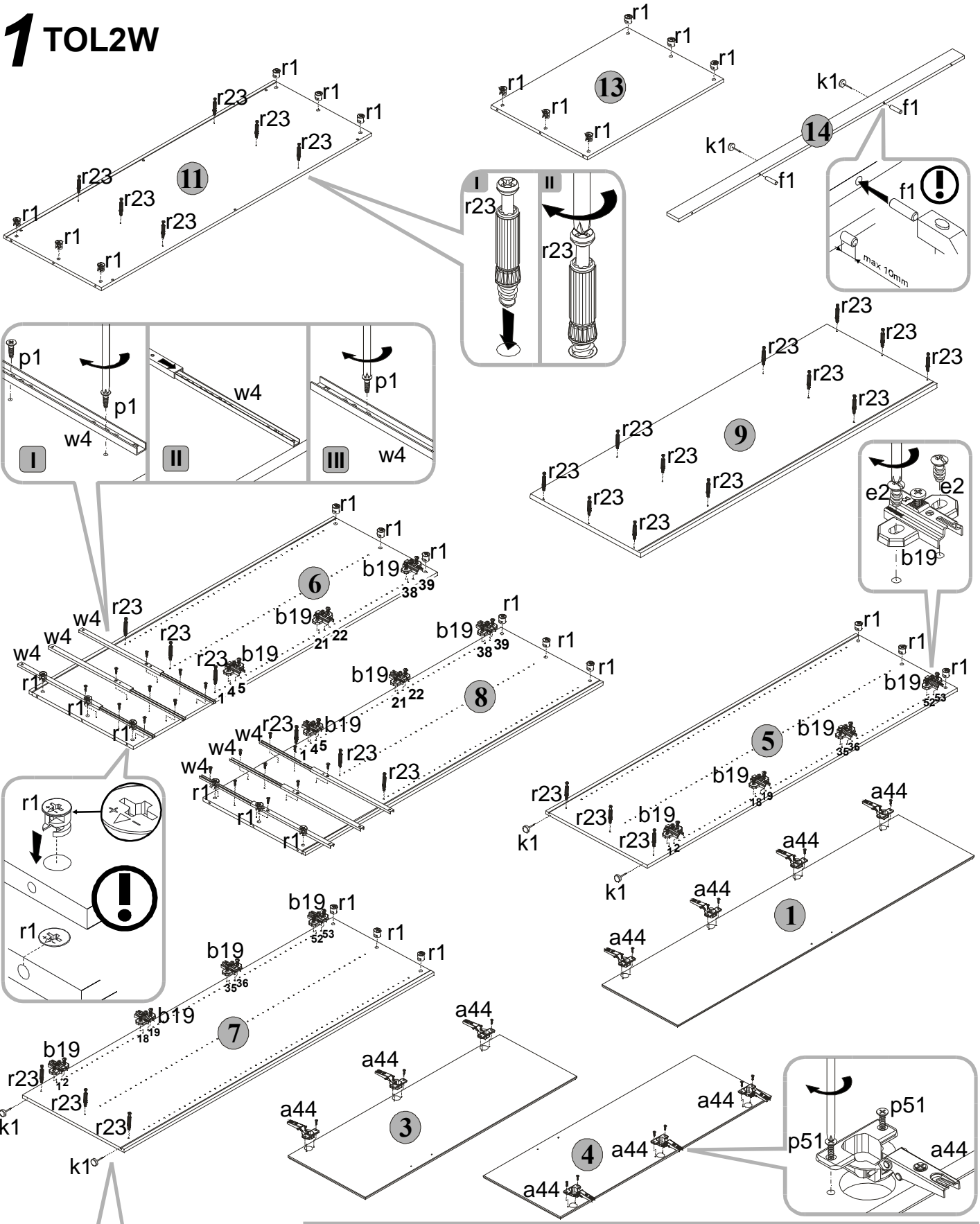

You need for fitting-up:

14x a44	14x b19	28x e2 φ6.3x13 mm	4x f1 φ8x30 mm	8x k1
18x p1 φ3.5x13 mm	40x p51 φ3.5x15 mm	30x r1 φ15x12mm #16	30x r23 30/11	6x w4 310 mm



Assemble the unit as shown in the pictures using indicated connectors and/or joints.

2 TOL2W

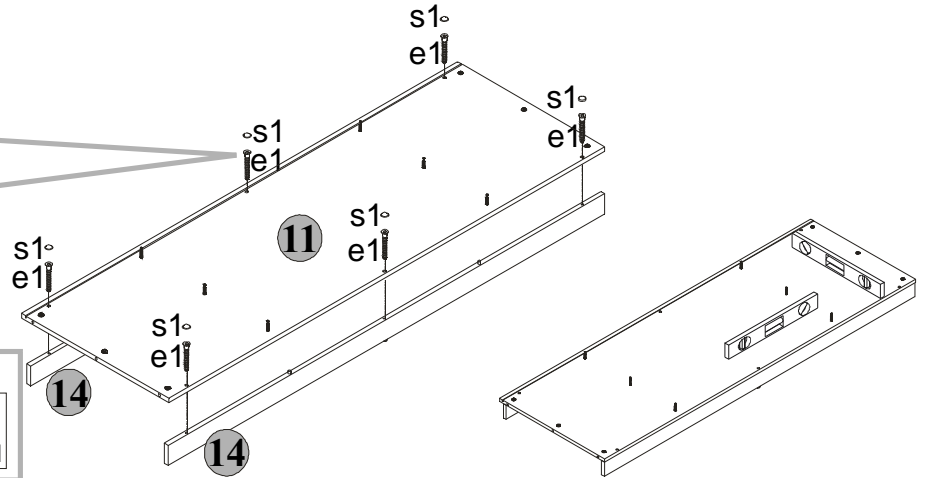
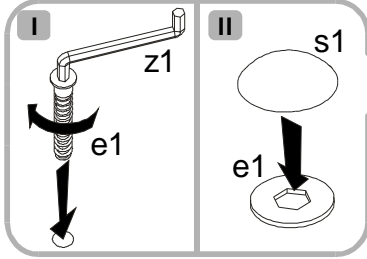

You need for fitting-up:

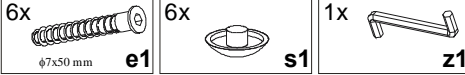

3 TOL2W

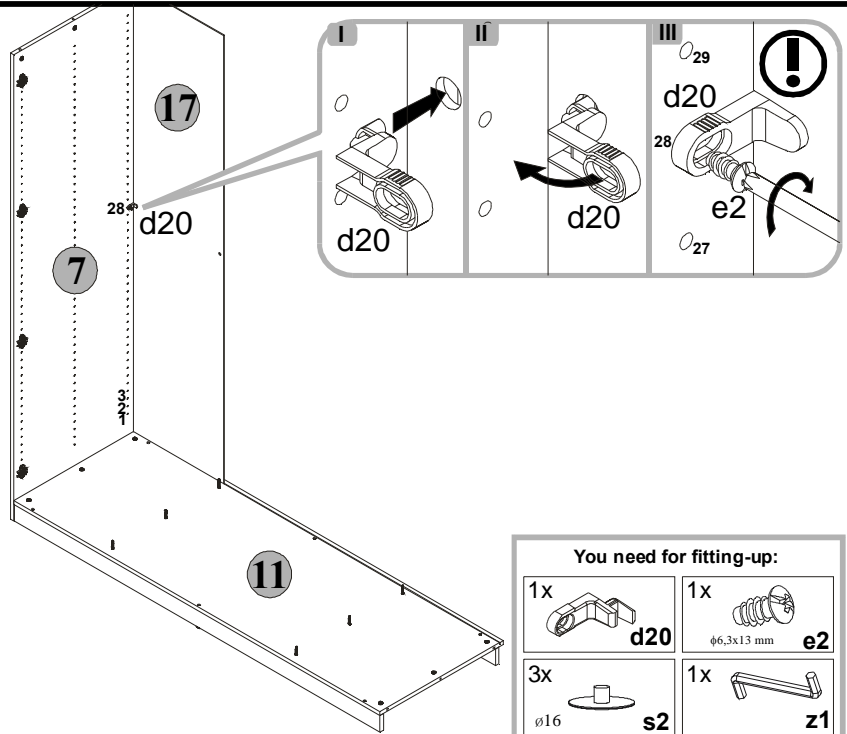
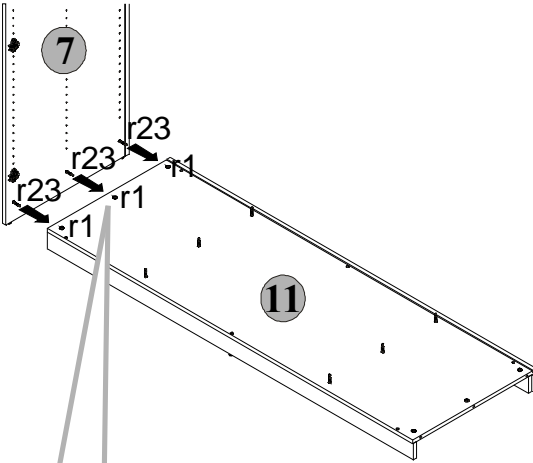

You need for fitting-up:

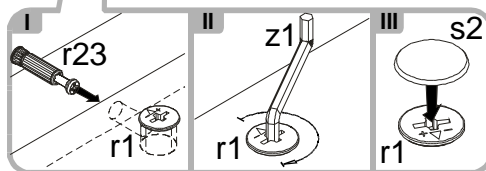

4 TOL2W

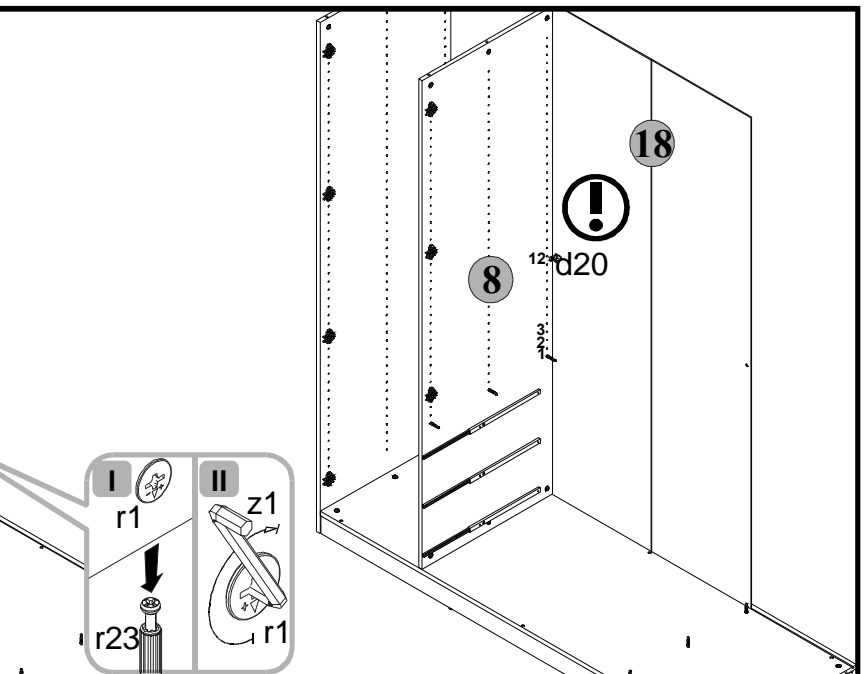
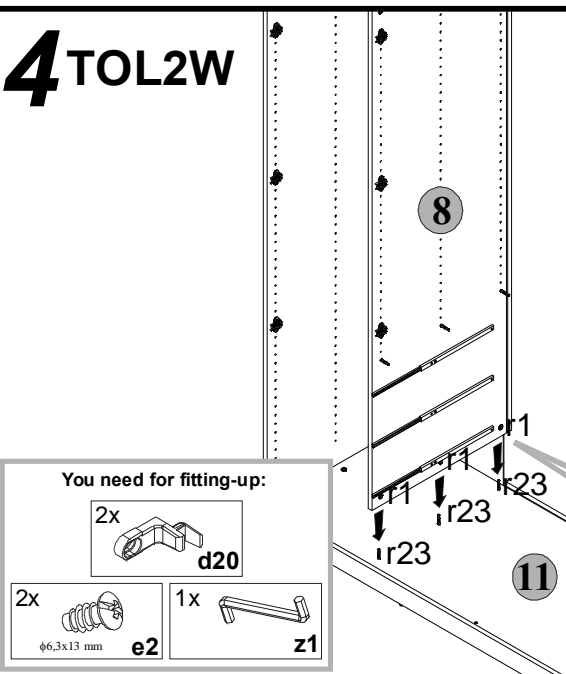

You need for fitting-up:

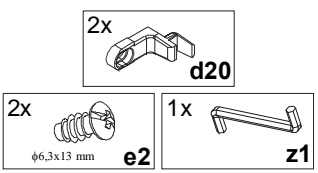

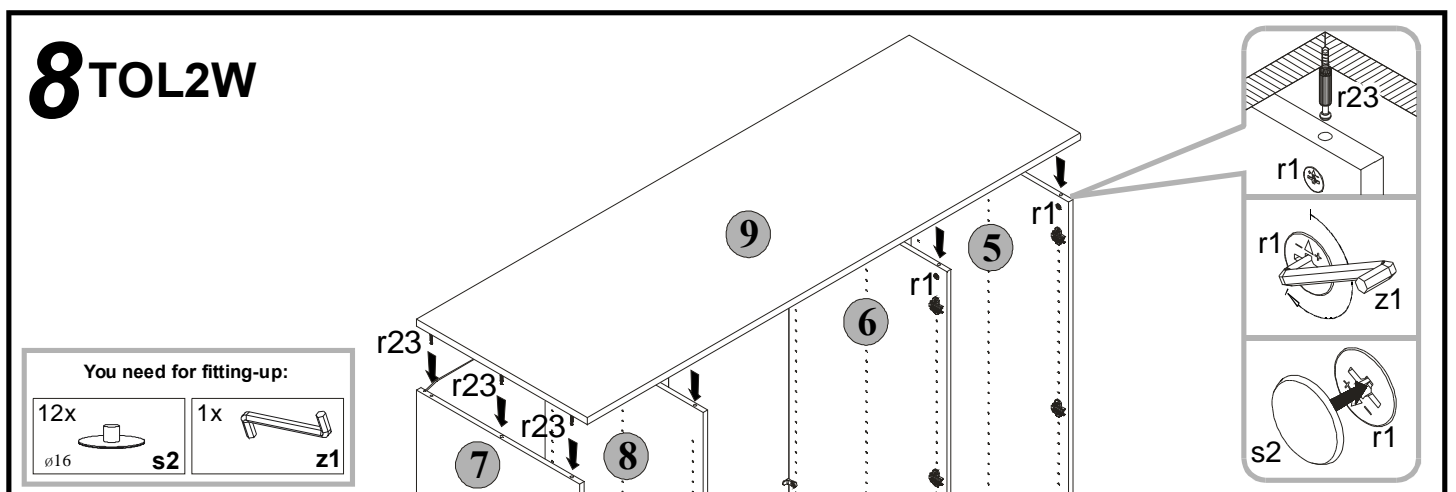
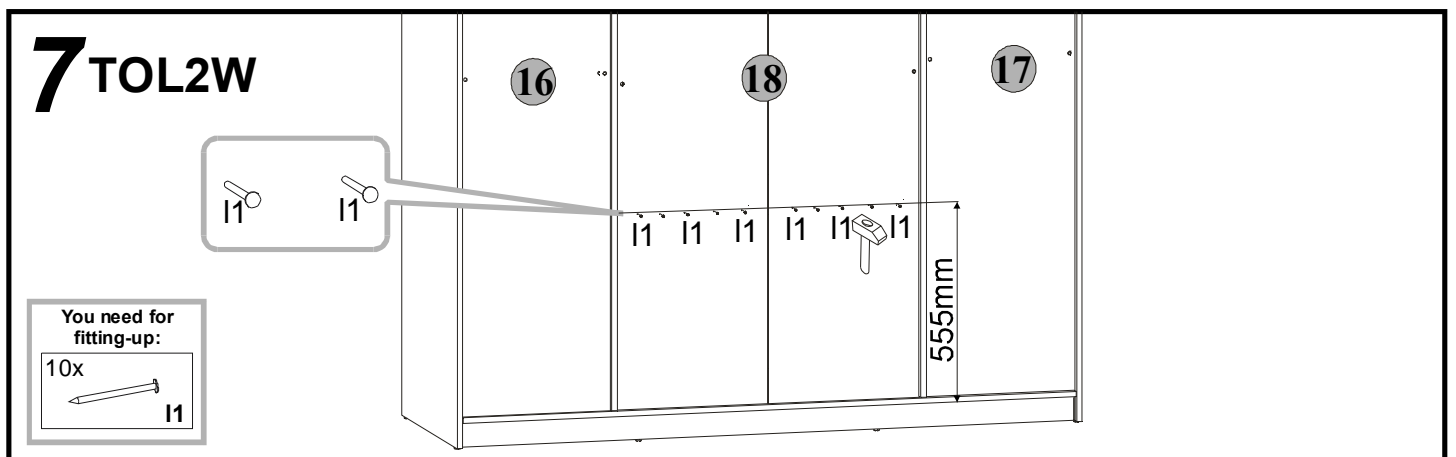
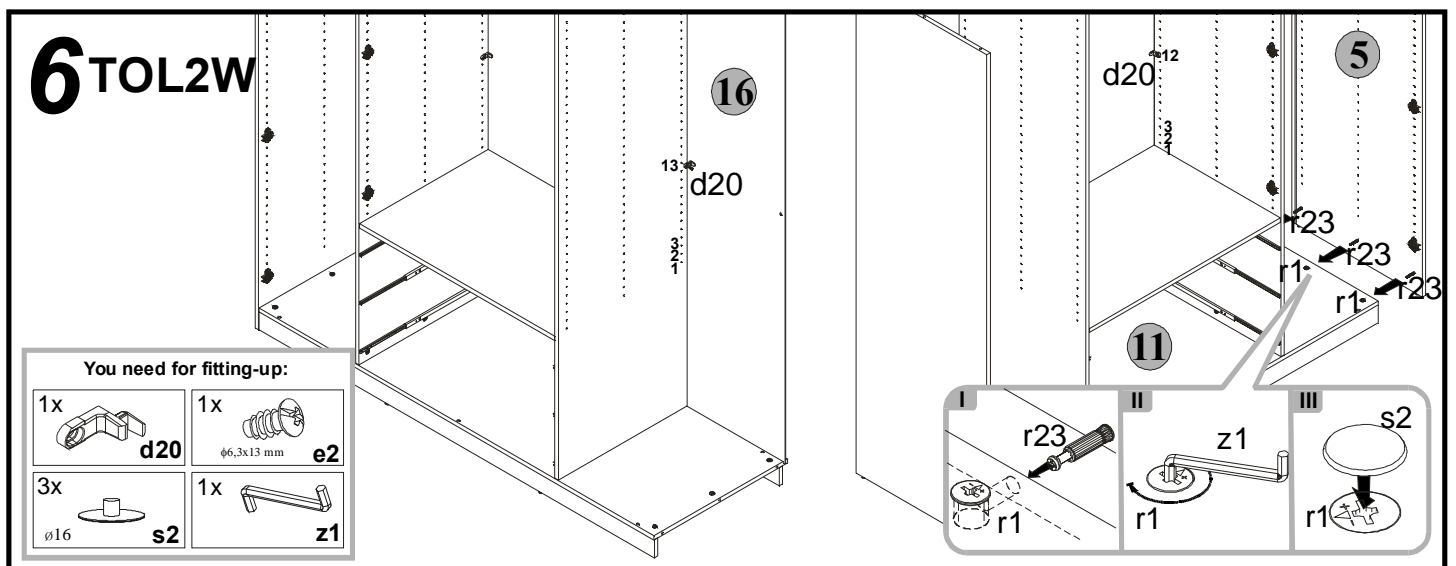
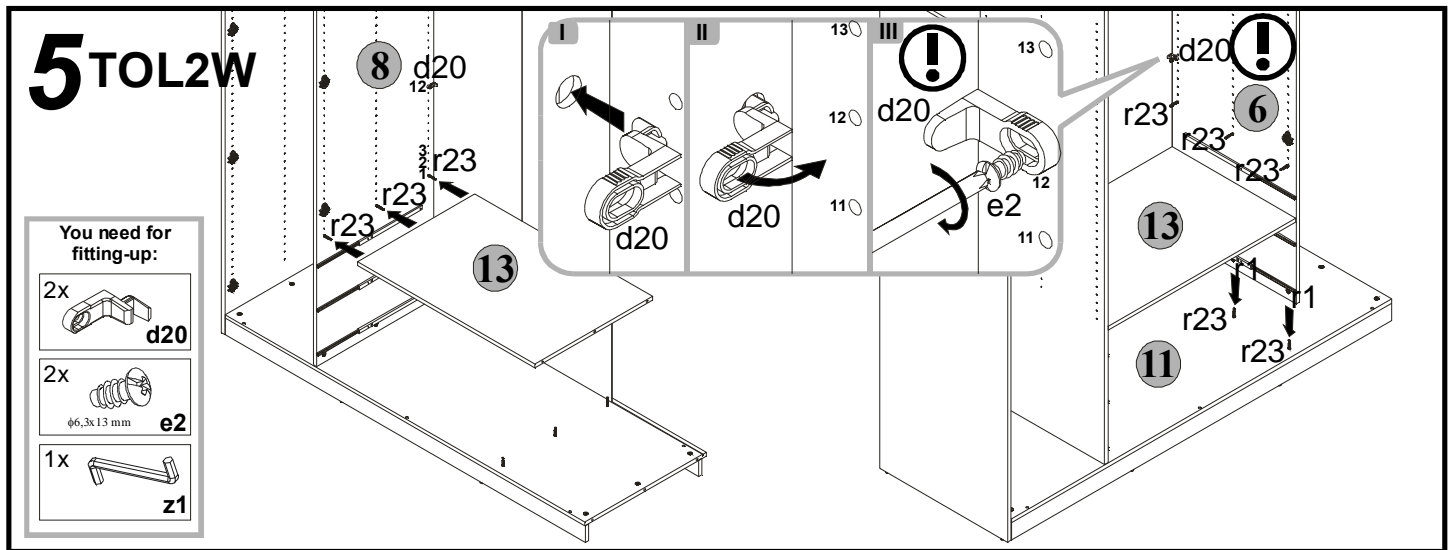

9 TOL2W

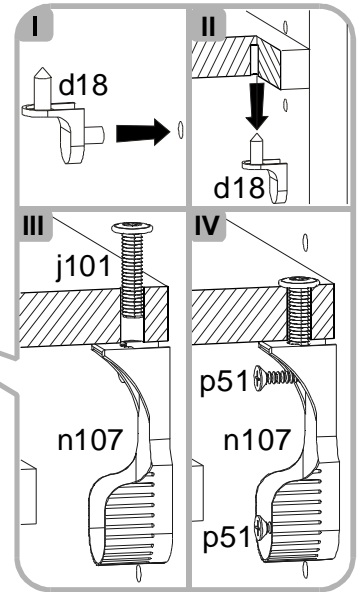
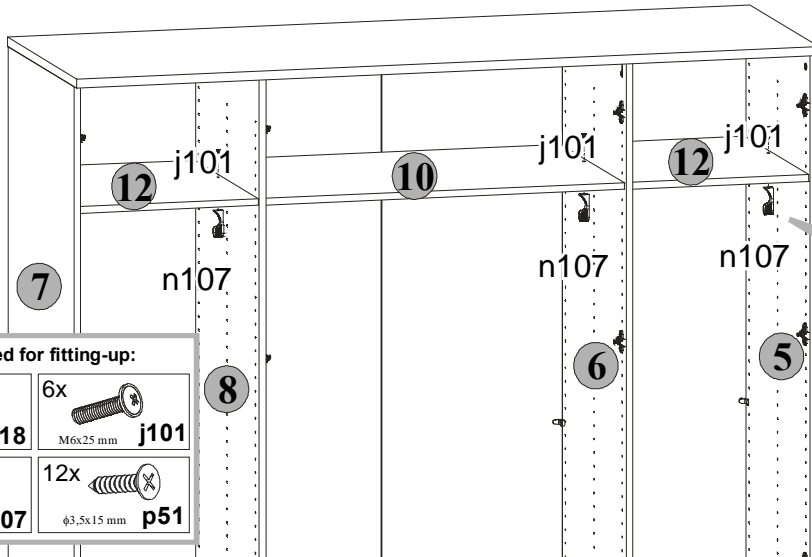

You need for fitting-up:

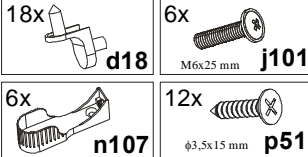

10 TOL2W



Attention: The assembly of the drawer should be done very carefully in order to avoid damaging the delicate joints of the drawer band.



Place y1 glue in the holes in the component shown, mount the component and leave while the glue dries.

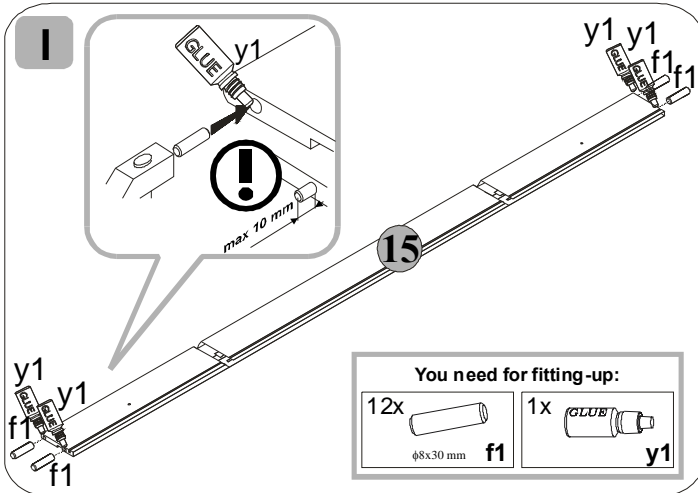

You need for fitting-up:

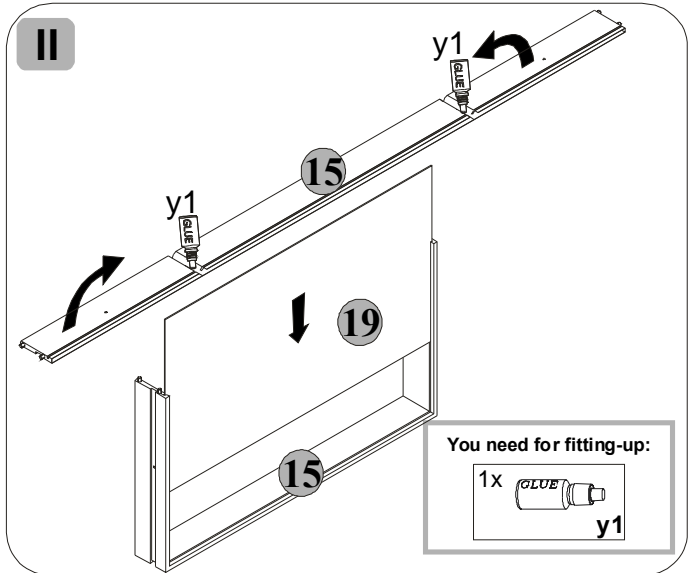
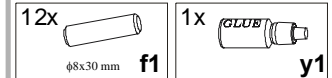

You need for fitting-up:

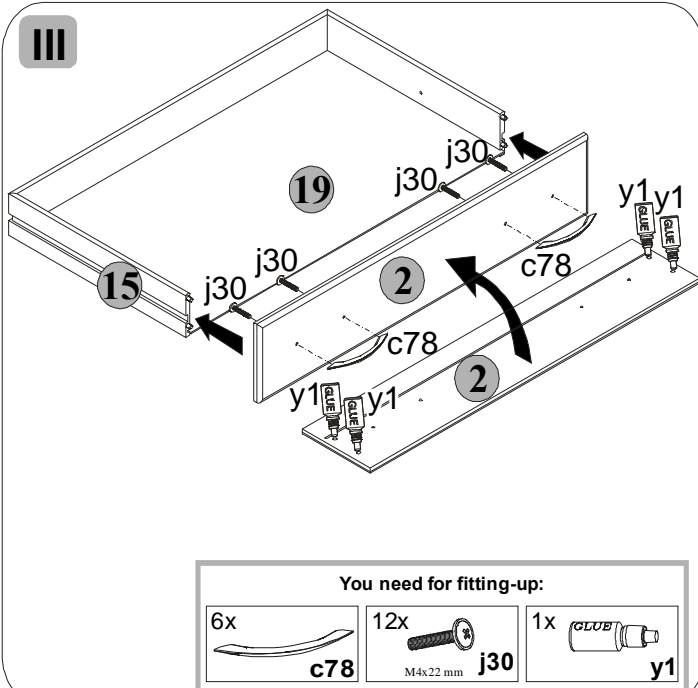
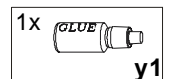

You need for fitting-up:

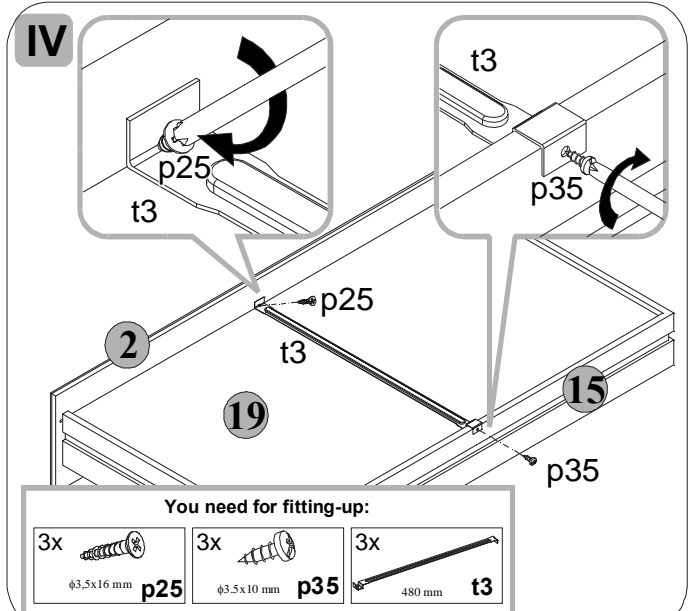

You need for fitting-up:



