

THE ASSEMBLY MANUAL

Attention: Before you start the assembly, please get acquainted with the entire assembly manual and stick to the order of assembly presented in this manual.

TOLEDO RANGE

Cupboard 6s

Symbol elementu Značka dílu Element symbol Jel elemek Symbol elementu	Wymiary Rozměry Measurements Nagyság Rozmery	Kód Kód Code Kód Kód	Paczka Krabica Paket Csomagban Balik
1	954x152	S44-002	2/2
2	476x152	S44-003	2/2
3	476x152	S44-004	2/2
4	846x417	S44-103	1/2
5	846x417	S44-104	1/2
6	139x397	S44-105	1/2
7	960x447	S44-203	1/2
8	926x70	S44-403	2/2
9	320x100	S44-517	2/2
10	320x100	S44-518	2/2
11	895x100	S44-521	2/2
12	424x100	S44-522	2/2
13	906x320	S44-904	1/2
14	936x847	S44-906	1/2
15	435x320	S44-907	1/2

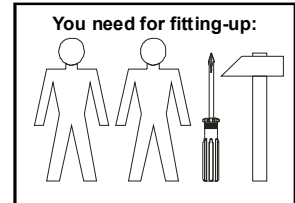
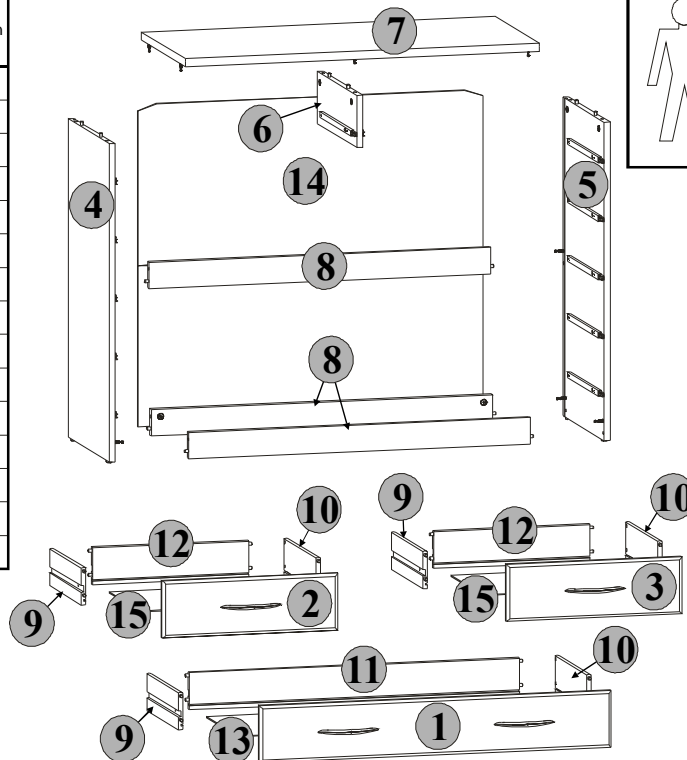

The symbols and the amount of accessories needed for the assembly have been presented below. The accessories can be found in the "Accessories" package.

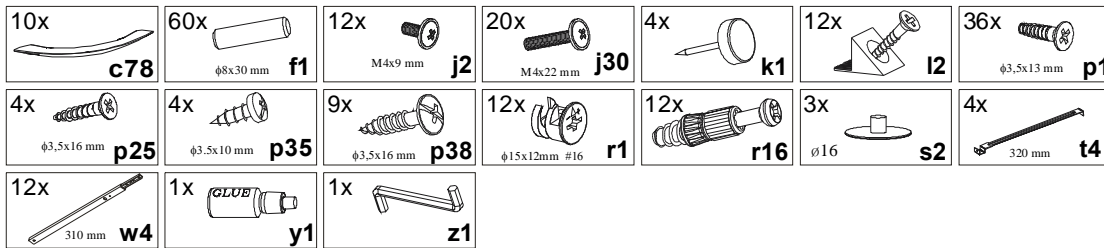
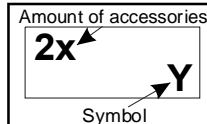

General instructions for furniture assembly

Attention

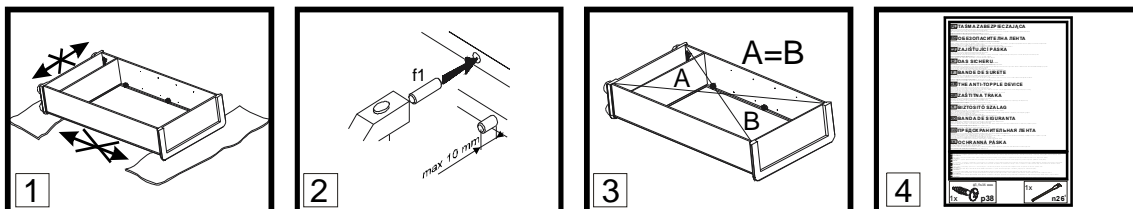

Attention:

- During the assembly, the elements should be put on a soft and clean surface, e.g. a towel or a blanket. Do not assemble the piece on a carpet or floor covering, etc.
- Drive *f1* pegs into the holes (8 mm in diameter) located along the edges of each element (leave the holes for the eccentric connector pivot free). **Attention:** In case a peg in one of the holes protrudes more than 10 mm, it should be hammered down, exchanged or shortened because it may cause damage to the side of the piece of furniture during its assembly.
- Before nailing a fiberboard, make sure that the diagonals are equal.
- The anti-topple device. When assembling the furniture follow the instructions in the manual. Improper fixing of the piece of furniture may cause it to topple when it is used.

INFORMATION!

Dear client, in case of complaining, please use the code number given in the assembly instruction. Any comments and complaints should be reported at the furniture purchase outlet. **Note!** Do not use any parts showing any faults or marks of damage.



Assemble the unit as shown in the pictures using indicated connectors and/or joints.

2 Cupboard 6s

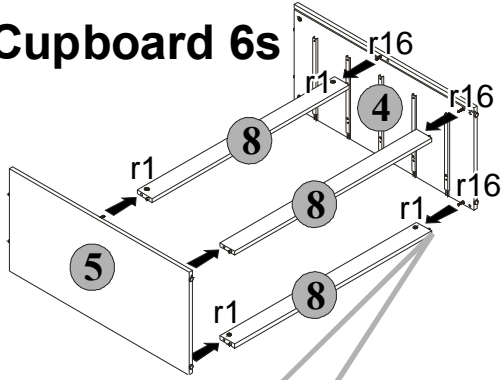

You need for fitting-up:

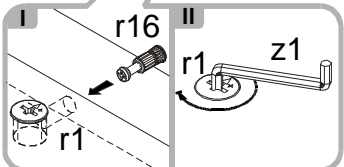

3 Cupboard 6s

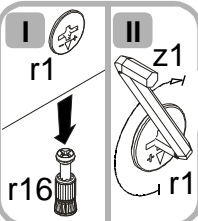
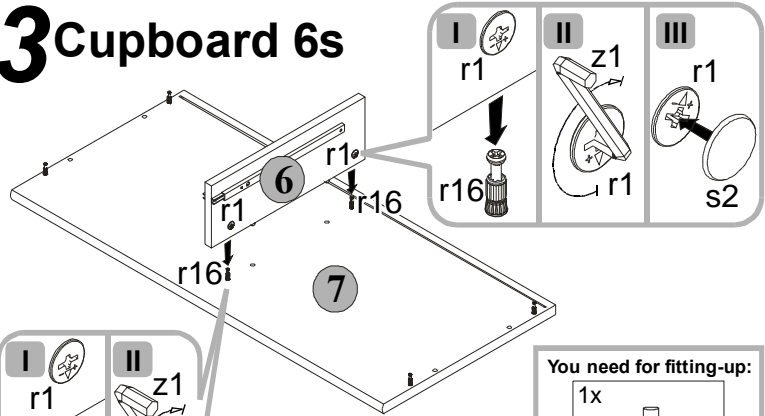

You need for fitting-up:

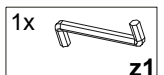

4 Cupboard 6s

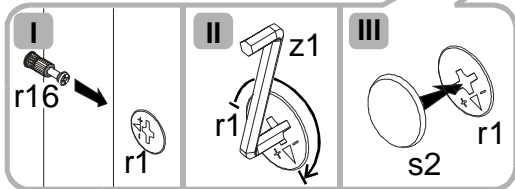
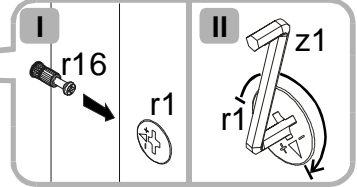
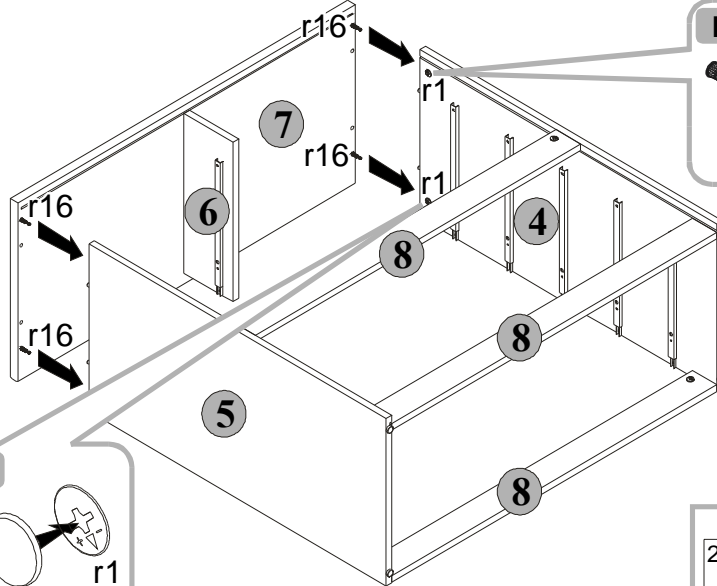

You need for fitting-up:

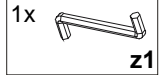

5 Cupboard 6s

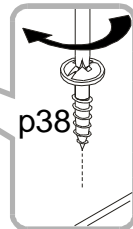
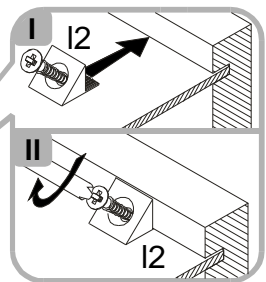
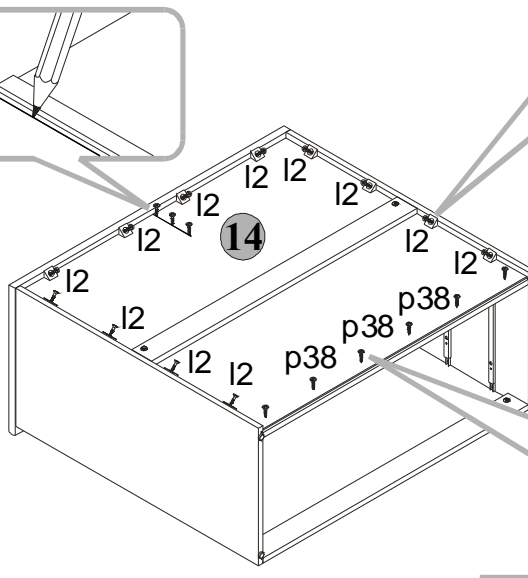
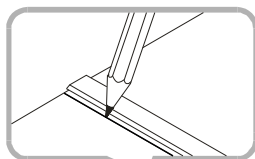
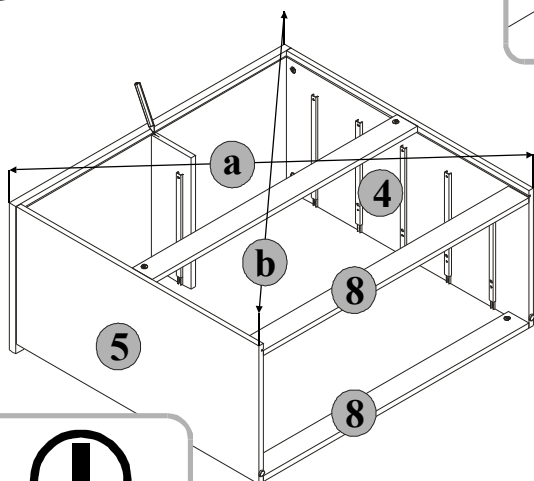

You need for fitting-up:

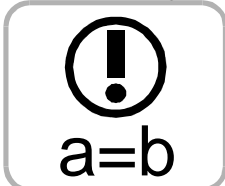

6 Cupboard 6s

I

You need for fitting-up:

48x		1x	
	φ8x30 mm		y1

II

You need for fitting-up:

1x	
	y1

III

You need for fitting-up:

10x		20x		1x	
	c78		M4x22 mm		y1

IV

V

You need for fitting-up:

4x		4x		4x	
	φ3.5x16 mm		φ3.5x10 mm		320 mm

7 Cupboard 6s

You need for fitting-up:

12x	
	M4x9 mm