

THE ASSEMBLY MANUAL,

Attention: Before you start the assembly, please get acquainted with the entire assembly manual and stick to the order of assembly presented in this manual.

TOLEDO RANGE Wardrobe 2d2s

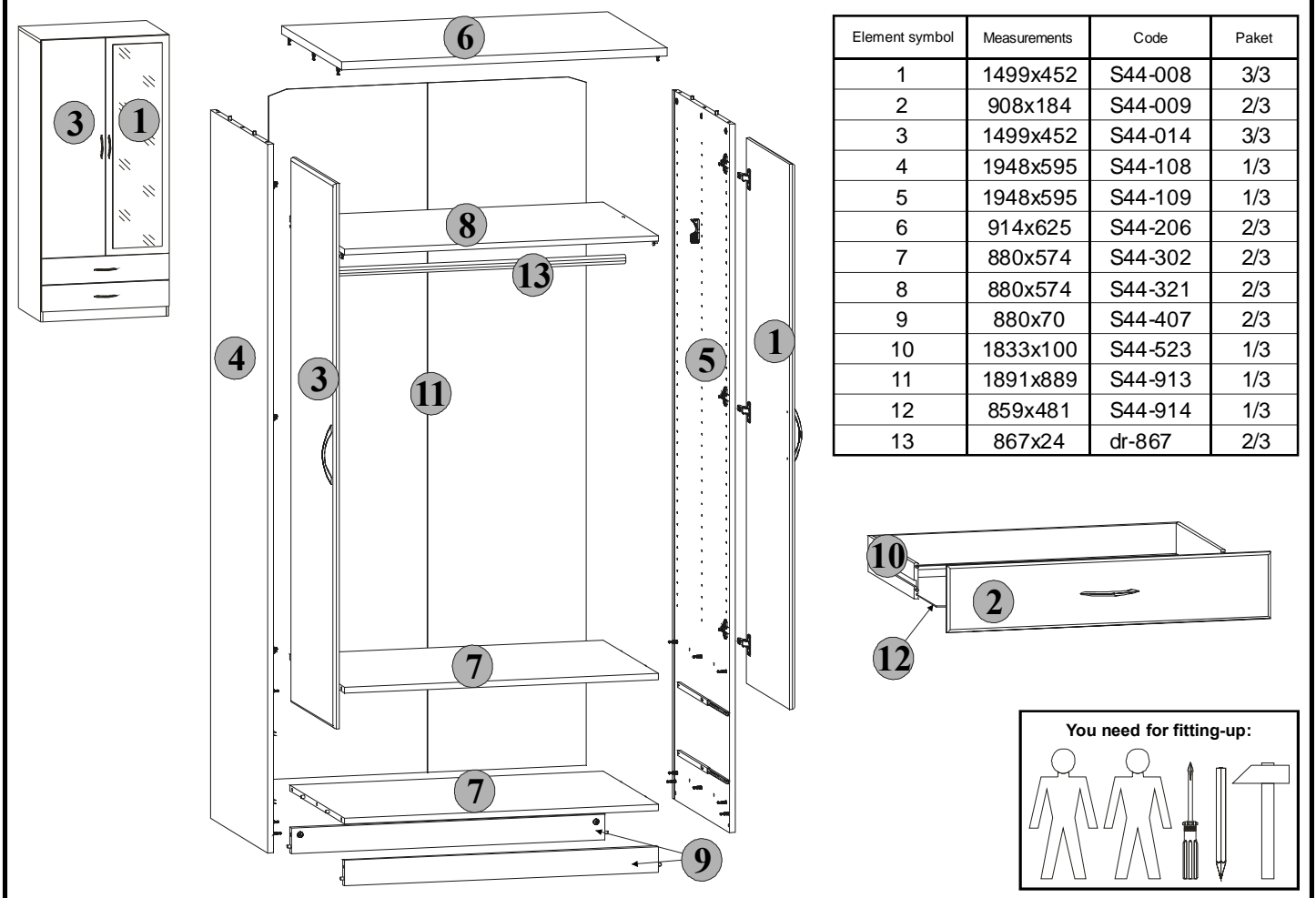

Element symbol	Measurements	Code	Paket
1	1499x452	S44-008	3/3
2	908x184	S44-009	2/3
3	1499x452	S44-014	3/3
4	1948x595	S44-108	1/3
5	1948x595	S44-109	1/3
6	914x625	S44-206	2/3
7	880x574	S44-302	2/3
8	880x574	S44-321	2/3
9	880x70	S44-407	2/3
10	1833x100	S44-523	1/3
11	1891x889	S44-913	1/3
12	859x481	S44-914	1/3
13	867x24	dr-867	2/3

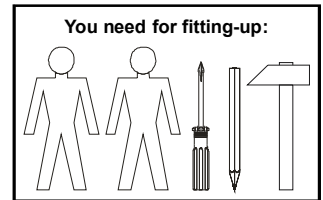
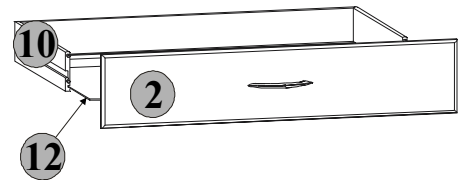

⚠ The symbols and the amount of accessories needed for the assembly have been presented below. The accessories can be found in the "Accessories" package.

6x d18	12x e2 φ6,3x13 mm	24x f1 φ8x30 mm	4x j2 M4x9 mm	8x j30 M4x22 mm	2x j101 M6x25 mm	4x k1
18x i2	2x n107	12x p1 φ3,5x13 mm	2x p25 φ3,5x16 mm	2x p35 φ3,5x10 mm	12x p38 φ3,5x16 mm	16x p51 φ3,5x15 mm
24x r1 φ15x12mm #16	24x r16	6x s2 φ16	2x t3 480 mm	4x w4 310 mm	1x y1 <i>GLUE</i>	1x z1

6x a44	6x b19 ^{D5}	4x c78
---------------	-----------------------------	---------------

<input type="checkbox"/> TASMA ZABEZPEČAČA	<input type="checkbox"/> OBEZOPASITELNA LENTA
<input type="checkbox"/> ZAJIŠTJUČI PASKA	<input type="checkbox"/> DAS SICHERU
<input type="checkbox"/> BANDE DE SURETE	<input type="checkbox"/> THE ANTI-TOPPLE DEVICE
<input type="checkbox"/> ZAŠTITNA TRAKA	<input type="checkbox"/> ВІЗТОСИТЬ СЗАЛІГ
<input type="checkbox"/> BANDA DE SIGURANTA	<input type="checkbox"/> ПРЕДОХРАНИТЕЛЬНА ЛЕНТА
<input type="checkbox"/> OCHRANA PASKA	

Amount of accessories: **2x** Symbol **Y**

General instructions for furniture assembly

Attention

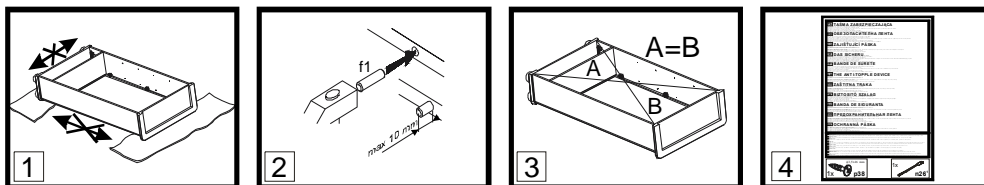

Attention:

- During the assembly, the elements should be put on a soft and clean surface, e.g. a towel or a blanket. Do not assemble the piece on a carpet or floor covering, etc.
- Drive **f1** pegs into the holes (8 mm in diameter) located along the edges of each element (leave the holes for the eccentric connector pivot free). **Attention:** In case a peg in one of the holes protrudes more than 10 mm, it should be hammered down, exchanged or shortened because it may cause damage to the side of the piece of furniture during its assembly.
- Before nailing a fiberboard, make sure that the diagonals are equal.
- The anti-topple device. When assembling the furniture follow the instructions in the manual. Improper fixing of the piece of furniture may cause it to topple when it is used.

INFORMATION!

Dear client, in case of complaining, please use the code number given in the assembly instruction. Any comments and complaints should be reported at the furniture purchase outlet. **Note!** Do not use any parts showing any faults or marks of damage.



The first stage of the assembly is equipping the elements with the appropriate accessories according to the drawings below. The Ⓞ symbols denote places to which special attention should be paid during the assembly.

1 Wardrobe 2d2s

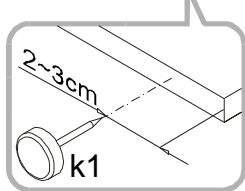
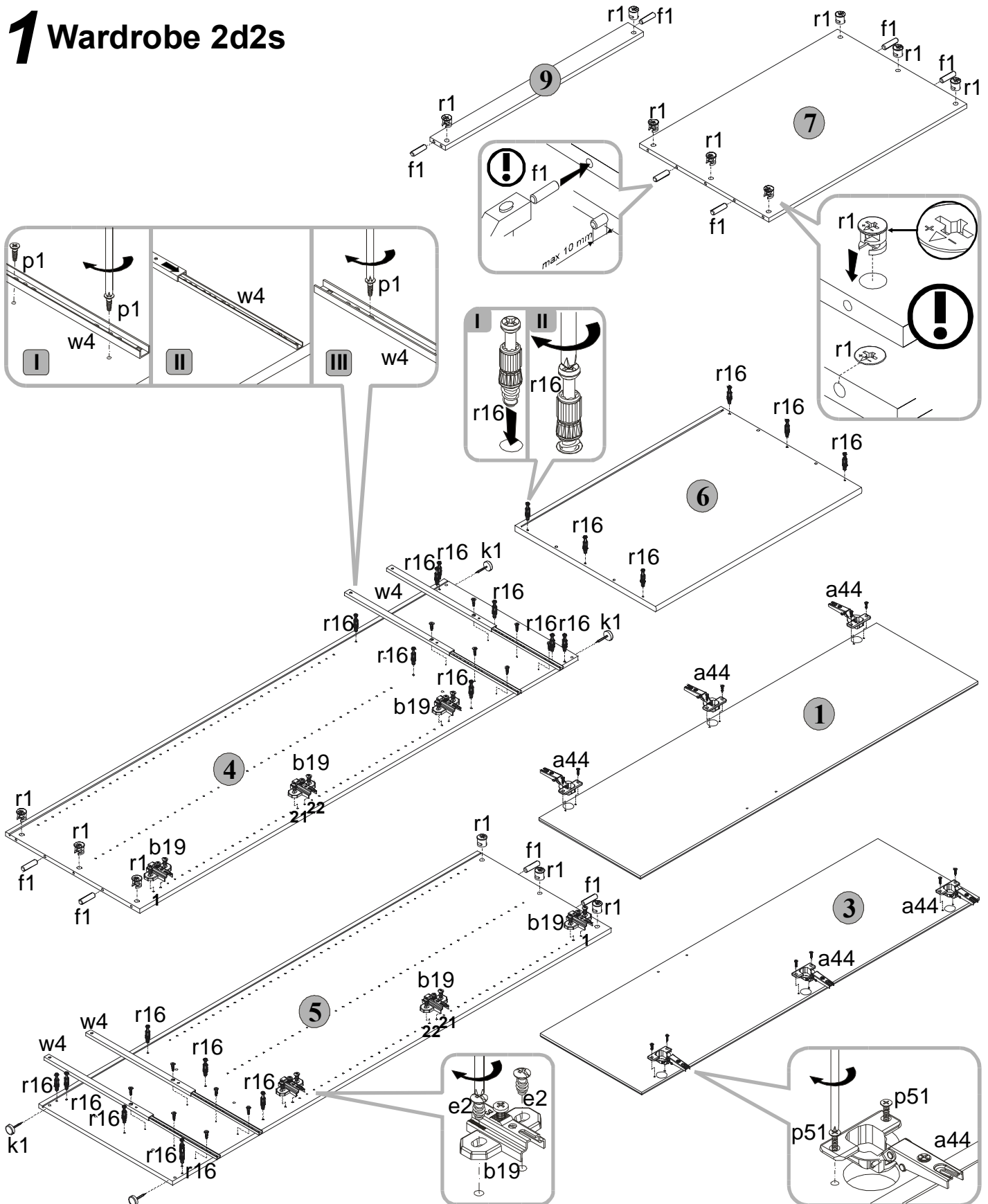

You need for fitting-up:

22x φ15x12mm #16 r1	22x r16	4x k1	6x a44	6x D5 b19	12x φ6,3x13 mm e2	12x φ3,5x13 mm p1	12x φ3,5x15 mm p51	16x φ8x30 mm f1	4x 310 mm w4
----------------------------------	-------------------	-----------------	------------------	------------------------	--------------------------------	--------------------------------	---------------------------------	------------------------------	---------------------------



Assemble the unit as shown in the pictures using indicated connectors and/or joints.

2 Wardrobe 2d2s

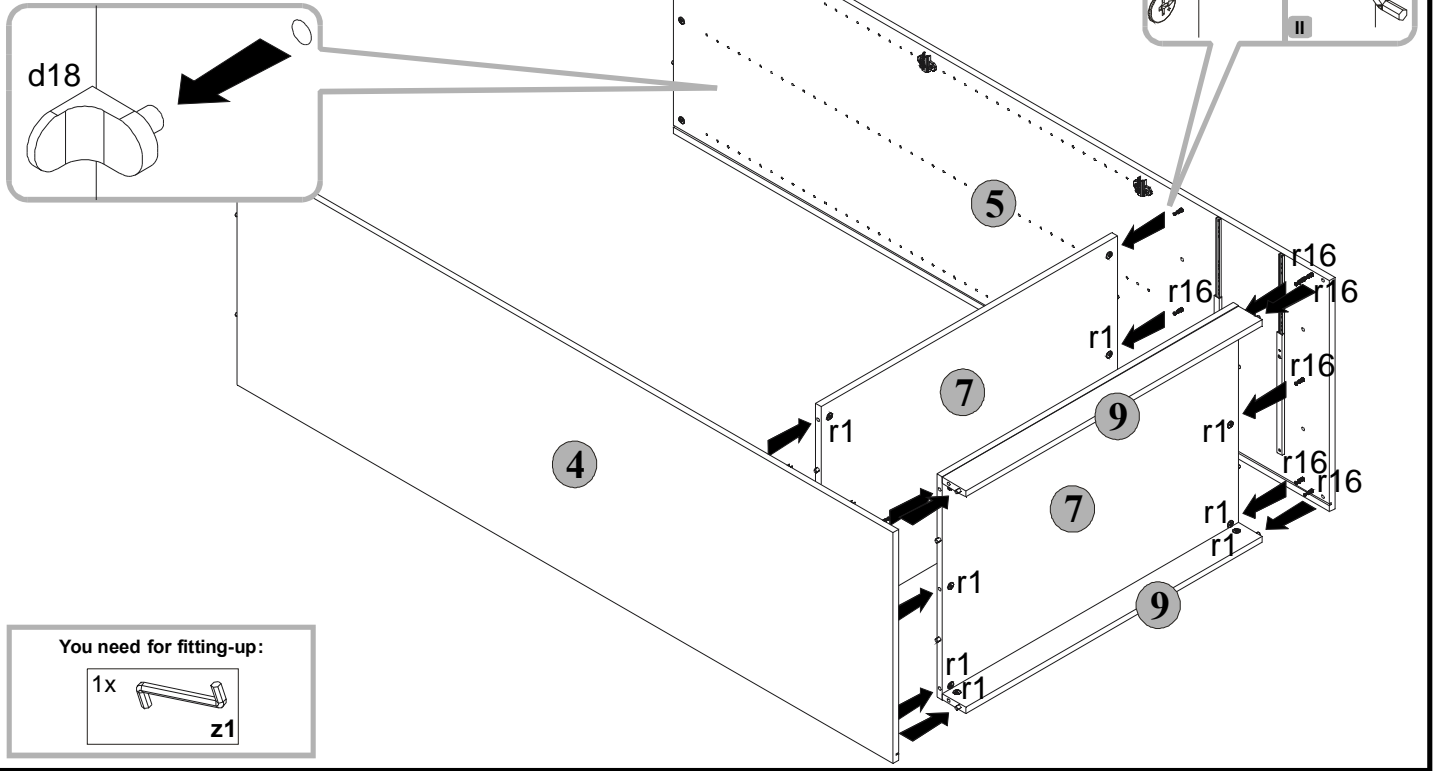

3 Wardrobe 2d2s

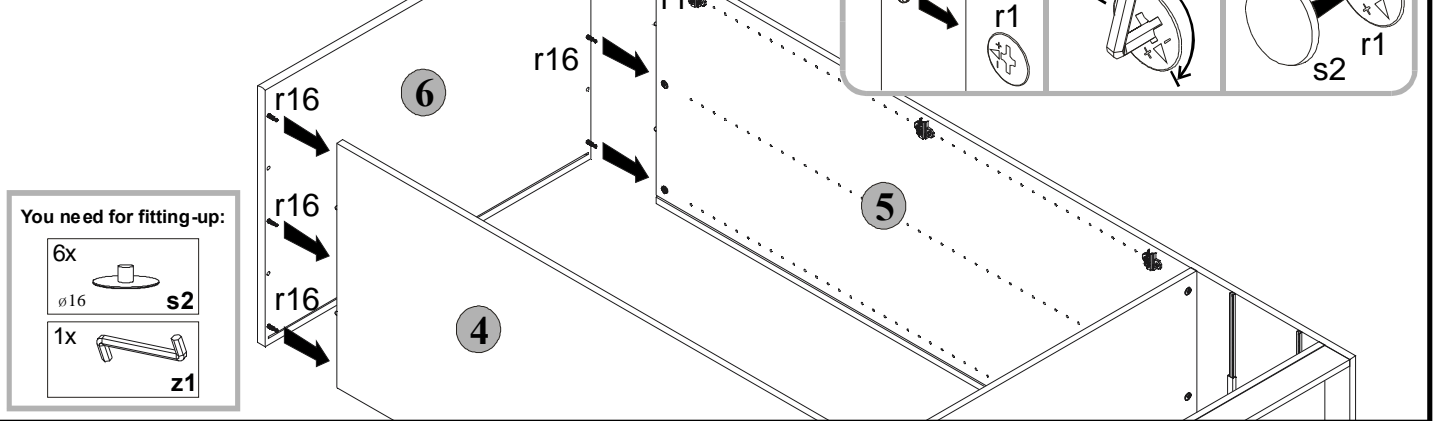

4 Wardrobe 2d2s

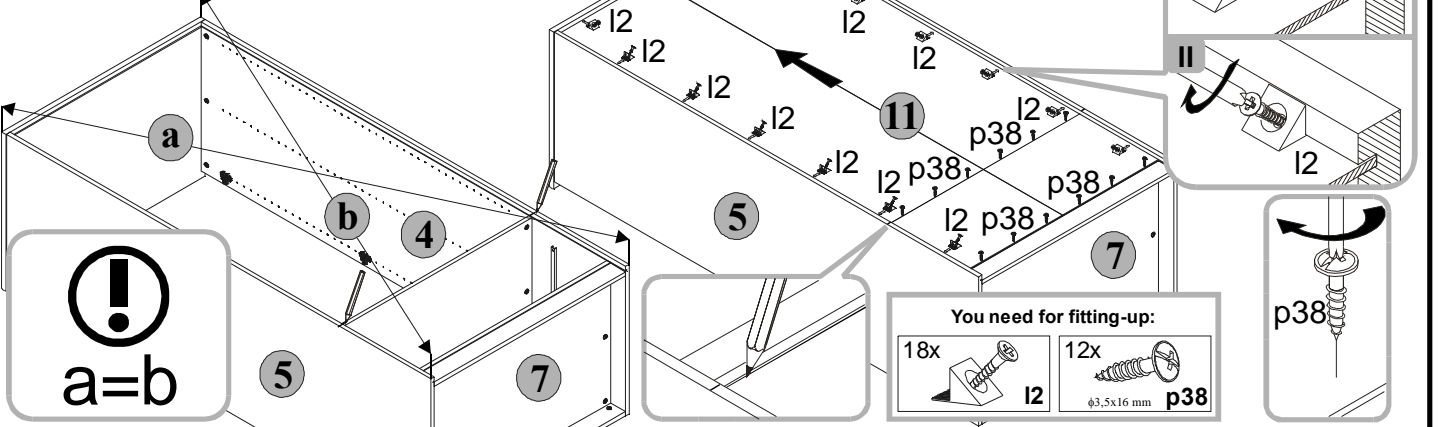

5 Wardrobe 2d2s

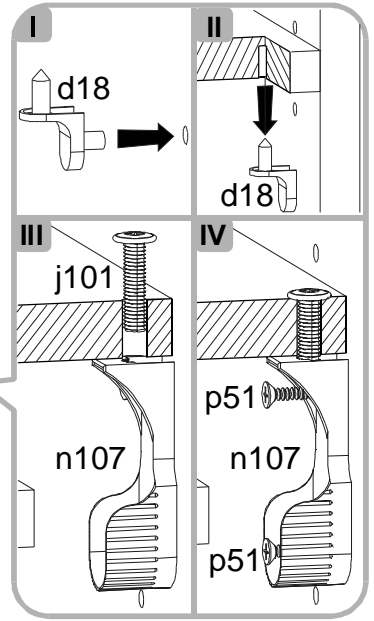
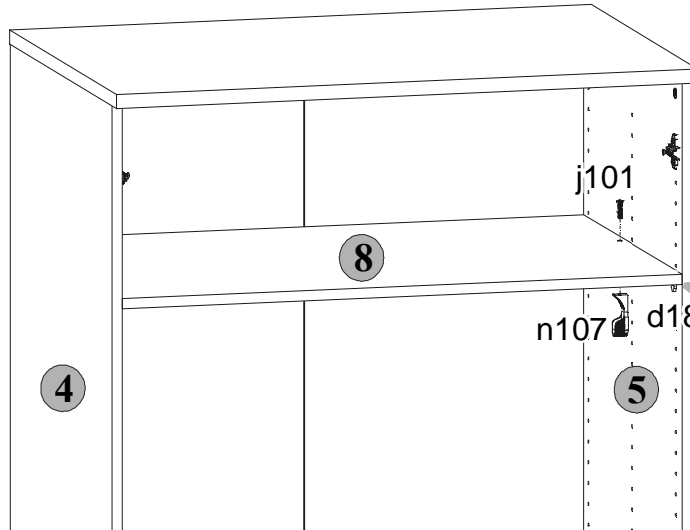

You need for fitting-up:

6x 	2x
2x 	4x

6 Wardrobe 2d2s



Attention: The assembly of the drawer should be done very carefully in order to avoid damaging the delicate joints of the drawer band.



Place y1 glue in the holes in the component shown, mount the component and leave while the glue dries.

I

You need for fitting-up:

8x 	1x
--------	--------

II

You need for fitting-up:

1x

III

You need for fitting-up:

2x 	4x 	1x
--------	--------	--------



IV

You need for fitting-up:

2x 	2x 	2x
--------	--------	--------

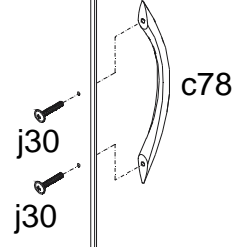
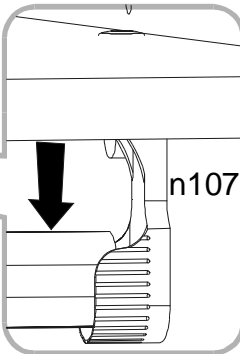
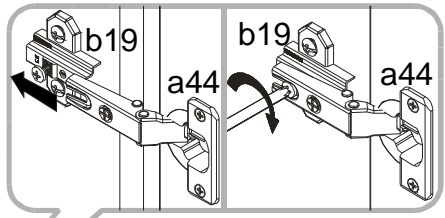
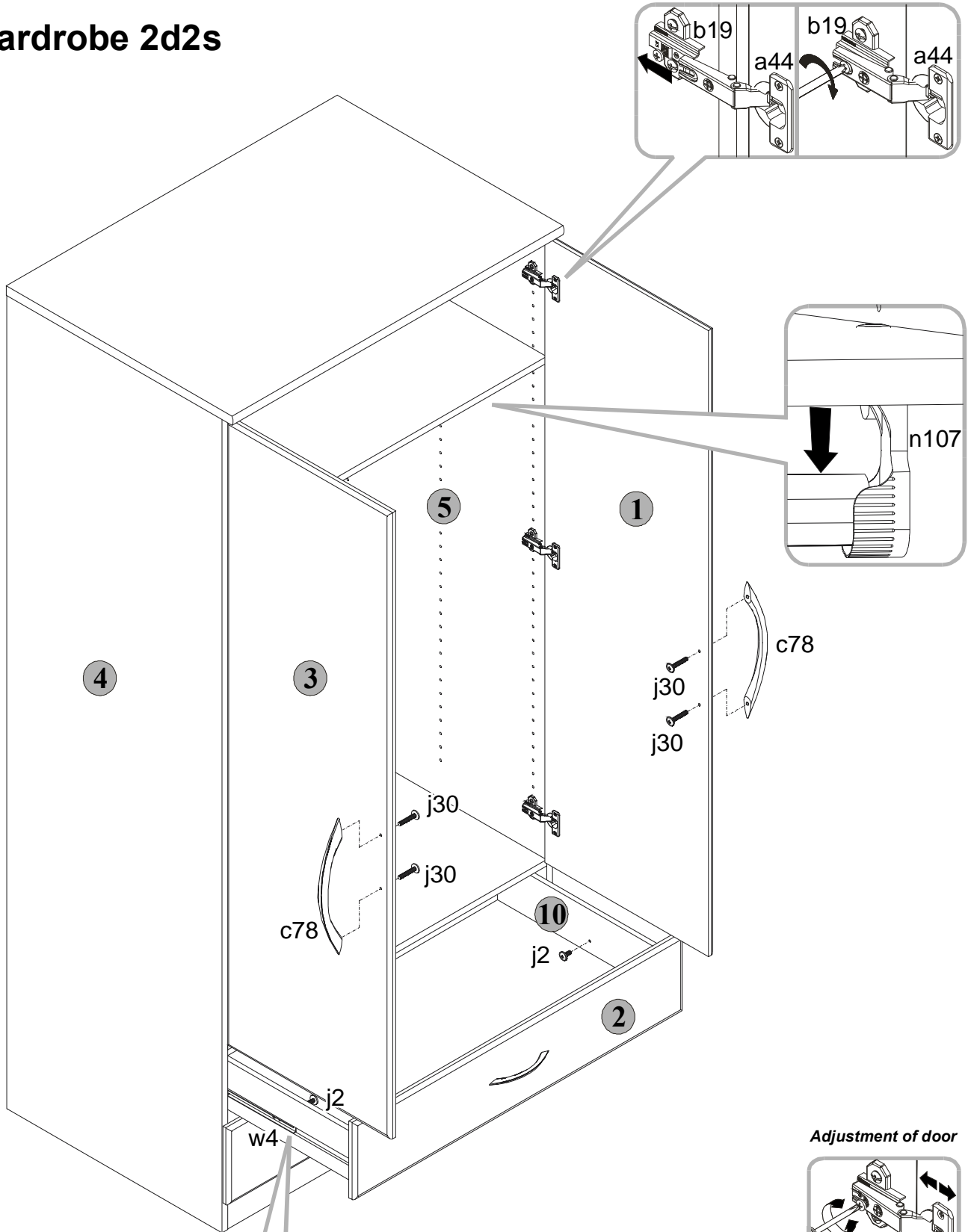
7 Wardrobe 2d2s



- You need for fitting-up:**
- 2x  **c78**
 - 4x  **j2**
M4x9 mm
 - 4x  **j30**
M4x22 mm

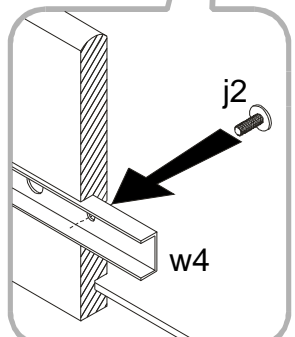

Adjustment of door

